

TOMBSTONE INSCRIPTIONS

OF

PERU, MASSACHUSETTS

Copied and presented by

Mrs. Max Lederer - Southamptn, Mass.

and

Mrs. Homer Granger- Chesterfield, Mass. in 1948

And

The Peru Cemetery and Historical Commissions

Every known tombstone In Peru

The following document, TOMBSTONE INSCRIPTIONS OF PERU, MASSACHUSETTS, was initially prepared during the autumn of 1948 by Mrs. Max Lederer of Southampton, Mass. and Mrs. Homer Granger of Chesterfield, Mass. and included every tombstone in Peru, to that date. A spiral-bound paper copy of this document is included in the Peru Library's Historical Commission files. To make this information more accessible, the original document was scanned and posted on the Town of Peru website. The original document remains in the Peru Library's collection.

This 2023 version provides an update since the 1948 document and includes corrections, when possible, along with all burials to date.

Corrections, clarifications and stories relating to family members and friends are welcome by the Cemetery Commission and Historical Commission. Many of the epitaphs are difficult to read and may become more legible due to cleaning and the direction of the light of day. The Cemetery and Historical Commission would welcome any additional photos and input.

One goal of the Cemetery Commission is to identify those who served our nation in uniform and are interred in our cemeteries. These individuals are marked with VETERAN after their names in this book. Some veterans are clearly identified by their headstone inscriptions, others are not. Any help from families, friends and town members in identifying veterans would be greatly appreciated and will allow their graves to be appropriately recognized on Memorial Day.

Many thanks to Mrs. Lederer and Mrs. Granger for their efforts and scholarship as well as to the members of the Cemetery and Historical Commissions, past and present, for their commitment to preserve the Town of Peru's history. This was no easy task!

Jim Kenney (jimkenney21@gmail.com)
Chair, Peru Cemetery Commission
November 2023

CONTENTS

CENTER CEMETERY	4 - 77
NORTH (PIERCE) CEMETERY	76 - 96
SOUTH (WHEELER or MIDDLEFIELD ROAD) CEMETERY	97 - 118
Ford Family Cemetery	119
South Thompson Burial Ground	120
Dorothy Francis Rice WildLife Sanctuary	121
South Road Extension Cemetery	122
Garnet Mountain Crash Site	123
Frequently Asked Questions (FAQs)	124
Map of North Cemetery	125 – 126
FULL CEMETERY INDEX	127 - 143

CENTER CEMETERY

FROM 1948 BOOK: The cemetery was first discussed at the March 1777 Annual Town Meeting. However, the first burial at that location occurred in 1776. This cemetery is located on South Road just south of the center of Peru, and it is on a hillside plainly visible from the Center, which consists of a church and a town hall, a few houses and the town library.

2023 Update: The cemetery is in a state of improving appearance. Many of the stones which had been flat on the ground have been re-set, and mowing has improved the general appearance of the cemetery. Veteran's headstones and others have been cleaned.

It is likely that Center Cemetery is the highest elevation above sea level cemetery in the Commonwealth of Massachusetts at 2071ft / 631m. The specific location of the cemetery is 42.436214 -73.048836. This cemetery is included in the Massachusetts Cultural Resource Information System (MACRIS) database.

The organization for mapping the location of graves has been updated. The cemetery map is organized on a grid using Columns 'A' through 'I' and Rows 1 – 12. Headstone locations will be shown by location on the grid. Each grid box measures approximately 50 feet wide by 25 feet deep. Headstone locations within the grid box are listed from right to left and front to back.

		Columns									
Rows	A	B	C	D	E	F	G	H	I	Rows	
12	A12	B12	C12		E12		G12		I12	12	
11				D11		F11		H11		11	
10	A10	B10	C10		E10		G10		I10	10	
				D9		F9		H9	I9	9	
		B8	C8		E8		G8			8	
				D7		F7				7	
						F6				6	
										5	
										4	
										3	
										2	
										1	

Opening in Stone wall

Denotes no graves in this section

Parking

Entryway

Grid boxes are approximately 50' wide x 25' high North →

← South Road →

SECTION A
Section A10

LITTLE

In
memory of
Amos H. Little
who was instantly
killed by the fall
from a Horse.
Aug. 23, 1835,
AE. 22.

Epitaph: I've seen a lovely garden flower
In all its beauty glow
I've seen a stormy halestone shower
Lay all its beauty low
I've seen a lovely blooming youth
In highest health today
(The remainder has been broken off but likely reads:
Before to-morrow's evening tide.
A breathless lump of clay.)

Mr.
Samuel E. Little
died
April 20, 1837
Aged 26 years.

GLEASON

Laura E. M.
Daughter of
J.B. & R.
Gleason
died
June 21
1837.
AE. 9 Mon's

CONE

In
Memory of
Olive Cone
who died
July 27, 1833
aged
35 years.
Epitaph: From death's arrest no age is free

Reader prepare to follow me

Father
Dea. Samuel Cone
Born
Feb. 2, 1803
Died
Jan 31, 1882.
Epitaph: Asleep in Jesus

The grave of
Mrs. Anna
wife of
Samuel Cone.
who died
Sept. 14, 1834
AE 27.
Epitaph: How sweet she shone in social life
As daughter sister friend and wife
Her race was swift her rest is sweet
Her joys sublime her bliss complete

Martha Ann
daughter of
Samuel & Anna
Cone Died
March 10, 1843
AE 8 1/2yrs.

Mother
Emeline Cone
Born
Jan. 26, 1805.
Died
Sept. 10, 1889.
Epitaph: Blessed Sleep

Section A11

SCOTT

Mr.
Peter Scott
died
June 29 1835
AE. 65.
Epitaph: He died with a hope full
of immortality

SEARS

In Memory of Darwin Rush, son of Headstone has disintegrated
Doct. Thomas and Sophia Sears Grave is in proximity to Peter Scott
who died April 6th 1817
Aged 14 months.

FRESHLER

David L Freshler
SP4 US Army
July 12 1938 Aug 24 2009

VETERAN

STEDMAN

Stacey D. Stedman
May 8, 1964
May 20, 1964

Section A12

MESENTER / CASE

Front: Cyrus Messenger – 1789 - 1870
Hannah Case, His Wife - 1794 – 1864
Back: Cyrus Messenger 1816 - 1816
Alvin H. Messenger 1828 - 1829

CURTIN

Frederick John Curtin
Husband of Dorothy Deveraux
Buenos Ayres 1891
Dalton 1918

HOLT

In Memory of Helen Curtin
Wife of McPherson Holt
Buenos Ayres 1897
Chicago 1922

CURTIN

Dorothy Deveraux
Curtin
Wife of
Frederick John

Curtin
Born Aspen Colorado 1888
Died 1968

TAYLOR

Henrietta Cowenhoven Taylor
Wife of
Loomis Hammond Taylor
Daughter of
David R. C. Brown
June 20, 1889 – June 27, 1962

SECTION B
Section B8

LEALAND / LELAND

In
memory of
Moses Lealand
who died June
7, 1809 in the
37th year of
his age

Lenard Lelend
died
Nov. 11, 1831
Aet 34

Epitaph: Mysterious are the ways of
God ____ ____
Clouds and ____ ____ darkness
____ his mighty plan

GOLDTHWAIT

Calvin Goldthwait
Died
May 14, 1825
Aged 41 years.
Epitaph:

In memory of
Mary, wife of
Joseph Goldthwait
who died Dec. 29th, 1811
aged 76 years.

Also of

Joseph Goldthwait
who died Dec. 29th 1814
Epitaph: Death leaves a melancholy gloom
It makes an empty seat
Ye living mortals all must come
And join this long retreat

VETERAN

FRENCH

In memory of
Rebekah who died
Dec. 20th 1811 aged 13 years

Also
Parny, who died
Sept. 9, 1819
aged 14 years
Daughters of
Isaac & Sarah French
Epitaph:

Mr.
Isaac French
Died
Aug. 24, 1835
AE 67
Epitaph: Lord he was thine and not our own
Thou hast not done us wrong
We thank thee for that precious loan
Afforded us so long

Martha A.
daughter of
Otis & Mary
French died
March 5 1838
aged 17 ms.
Epitaph: So fades the lovely blooming
flower
Cut down & withered in an hour

Section B9

FRENCH

Julia Ann,
Dau. of
Sylvester & Sarah

French
Died
March 15, 1848
aged 21 years.
Epitaph:

Double Stone

Cornelius D.
who died Sept. 3rd,
1826 aged 2 years

Mary E.
who died Oct. 2d
1826, aged 3 years
& 11 months

Children of Sylvester & Sarah French.

Double Stone

In Memory of
Samantha Sofia
who died May 2, 1820
aged 11 months & 1 da

Sarah Maria
who died Mar 8th, 1826
aged 11 months
& 6 days.

Children of Sylvester & Sarah French.

In memory of
Cynthia, wife of
Silvester French
and daughter of Silvester
and Rebecca Robbins
who died May 25, 1814
in the 27th year of her age.
Epitaph:

Sarah,
Wife of
Sylvester French,
died Dec. 24, 1843.
Aged 49 years.
Epitaph: While in life, we are in death.

Sylvester French
Died
May 20, 1883,
AE 95 yrs. 11 mos.
Epitaph:

Edward N.
Son of
Sylvester & Belinda

VETERAN

French,
Member Co. C. 49th Mass. Vol.
Died
July 19, 1863
Aged 18 y'rs. 1 mo. 5 d's.
Epitaph: God's ways are not as man's way

Cynthia R. French
Born
Feb. 12. 1816.
Died
Oct. 26. 1891.

HANNUM

In
memory of
Allen Warner
son of
Athniel &
Patty Hannum
who departed this life
November 23,
1810 in the second
year of his age.

In
Memory of
Martha.
wife of
Othniel Hannum .
who died Jany 13th
1830: aged 49 years.
Epitaph: The paths of death with glory shine
When saints the call obey
A light from heaven an arm devine
Are with them on the way'

An old piece of marble that may be a part of Othniel Hannum's stone
No inscription, not decipherable

LOOK

Melvin F. Son of
Cheny & Rebec-
kah Look died
June 18th, 1823
in the 5th year
of his age.

Epitaph:

Albert F.
Son of
Cheney & Rebeckah
Look.
Died Jan. 6, 1850.
Aged 21 yrs.

Rebecca,
Wife of
Cheney Look
Died
Oct. 7, 1852
Aged 63 yrs.

From the 1948 version: Stone(s) missing which had been in this location

In Memory of Lucius A. Look, an adopted son of
Capt. Lucius & Jane Look – d. Oct. 4, 1814

Thomas A., Son of Lucius & J.L. Look
died Sept. 12, 1827 ae (15?) weeks.

In Memory of H.S.A. (?) Look
Adopted son of Lucius & Jane Look

Section B10

CONE

In
Memory of
Daniel Cone
Who died
June 28, 1842
AE 83
Epitaph: The righteous hath hope in his death

VETERAN

In
Memory of
Olive
wife of
Daniel Cone
Who died
Sept. 12, 1840
AE 76
Epitaph: Blessed are the dead who die in the Lord.

In
Memory of
Daniel Cone Jr.
who died
Nov. 10, 1832.
aged 32 yrs.
Epitaph: The just shall be had in everlasting remembrance

SPALDING

In
Memory of
Maj. Asa Spalding
who died
May 3, 1830:
aged 75 years.
Epitaph: Be still and know that I am God

VETERAN

The
Grave of
Mrs. Mary
wife of
Alfred Spalding
who died
Dec. 5, 1832
aged 41 yrs.

Also, an Infant child.
Epitaph: There is rest in Heaven

WORTHINGTON

Samuel
died
Feb. 27, 1838
aged 7 years.
David
died
Jan. 22, 1831
aged 2 mos.
Twin children of David & Mary Worthington
Epitaph:

In
Memory of
Mary
Wife of
David Worthington

Who died
Dec. 6, 1842
AE 46

HOLMES

Jane M.
Daughter of
Alvan & Rosanna
Holmes
died Jan. 15,
1843
Aged 16 months.

Mariah
Daughter of
Alvan & Rosanna
Holmes
died April 7
1837
Aged 4 yrs

GEER

Cordelia M.
daughter of
Sherman & Polly M.
Geer died
Feb. 10, 1855.
AE. 14 y'rs 9 mo's
Epitaph: Not dead but sleepeth

Chauncey B.
son of Sherman & Polly M.
Geer
died Feb. 16, 1843.
AE 6 weeks.

Infant died Nov. 16, 1844
Marilla N. - Nov. 1, 1846 ae 2 yrs.
Twin daur's of Sherman & Polly Geer.

Headstone significantly disintegrating

Polly M.
Wife of
Sherman Geer.
Died
May 6, 1848.
Aged 33 years.
1 mo. & 28 d's.
Epitaph:

Sherman Geer
Died
April 18, 1857.
AE. 45 ys.
Epitaph: He was killed by the fall of a barn.

Section B11

RODGERS

Edward Payson
Son of
Joseph W. &
Onnah Rodgers
Died
Feb. 6, 1838
AE 3 yrs. & 4 mos.
Epitaph:

The
Grave of
Onnah
wife of
Joseph W. Rodgers
Who died
Nov. 8, 1839
Aged 31 years.
Epitaph: Farewell my friends
Dry up your tears
My dust lies here
Till Christ appears

GEER

Benjamin J. Geer
Died
June 6, 1866.
Aged 60 yrs.
Epitaph: Gone Home

Find-A Grave provides the following:

Amelia O. Abbot
Born July 2, 1807 in Chester or Worthington
Died February 7, 1876 in Peru and buried in Center Cemetery
A photo of Center Cemetery suggests Amelia's grave to be between Benjamin Geer, her husband, and Anna Abbot, her Mother. An initial probe of the area was unsuccessful in locating a headstone

ABBOT

My mother

Anna Abbot
Died
Oct. 15, 1869.
Aged 83 yrs.
Epitaph: There is rest for the weary

PHILLIPS

In
Memory of
Lewis, son of
Mr. Smith &
Mrs. Lydia Phillips
Died Oct. 19th 1791
in the 2nd year of
his age.

In
Memory of
Chloe
Daughter of
Mr. Smith &
Mrs. Lydia Phillips
Died June 12th 1815
in the 5th year
of her age.

Persis
daughter of
Smith & Lydia
Phillips
Died
Oct. 30, 1816
AE. 2 yrs.
& 6 months.

In Memory of
Lydia Phillips
consort of
Smith Phillips who
departed this life
April 25th
1828 Aged 58 years.
Epitaph:

In VETERAN
Memory of
Dea. Smith Phillips
Who died
July 24, 1843
AE 82
Epitaph 1: Precious in the sight of the Lord is the death of his saints
Epitaph 2: The dead are like the stars by day,
(Remainder buried in concrete likely reads: Withdrawn from mortal eye,
Yet holding unperceived their way
Through the unclouded sky.)

GEER

In memory of VETERAN
John Geer
who died
Dec. 25, 1840
AE. 80.
Epitaph: Gone to the resting place of man
His long his silent home,
Where ages past have gone before
Where future ages come,

Onnah
Wife of
John Geer
Died
Nov. 20, 1845
AE. 81.
Epitaph: Her soul has now taken its flight
To mansions of glory above
To mingle with angels of light
And dwell in the kingdom of love.

BARKER

Lucy A.
Wife of
William C Barker
died Mar. 14, 1857
Aged 37 y'rs.
Epitaph: Sleep on dear friend and take thy rest
God called thee home he thought it best

PHILLIPS

Lydia Isabella
daughter of
Ebenezer &

Sarah Phillips
died Jan. 29, 1839
aged 19

Marilla.
daughter
of Ebenezer
& Sarah Phillips
died Jan. 2, 1839
Aged 14.

Mary Ann
daughter of Mr.
Ebenezer and Mrs.
Sarah Phillips
died March 26,
1816 aged 15
months.

Section B12

GEER

Maryett
Dau. of
Luther & Lyddia
Geer, died
July 4, 1855
AE. 22 yrs.

In
Memory of
Joanna,
wife of
Luther Geer.
Who died
Jan. 12, 1832
age 45 years
Epitaph: There is rest in Heaven

Luther Geer,
Died
March 30, 1853.
Aged 67 y'rs.
Epitaph: Prepare to meet your God

ATWATER

Allen

son of Leverett &
Abigail Atwater
died March 18, 1816
aged 10 months &
7 days.

GEER

Polly,
wife of
Peter Geer.
Died
May 17, 1834 aged 29 y'rs.

Peter Geer,
Died
June 13, 1868.
Aged 68 y'rs.
Sally L.
Wife of
Peter Geer
Died
Feb. 11, 1900.
AE. 85 yrs.

BALLOU

In
Memory of
Elias Ballou
who died
Jan. 2, 1834
AE 81

VETERAN

In
Memory of
Mary
wife of
Elias Ballou
(Remainder set in concrete: who died July 29, 1842 ae 88)

Lucinda
daughter of Amariah &
Mary Ballou
died Apr. 20, 1817
in the 4 year of her age

also Russell Son of d. Sept. 18, 1827 ae 11mo.

Amariah
Jr. Son of
Amariah & Mary
Ballou died
Aug. 19, 1827
in the 18th year
of his age

Amariah Ballou
Died
June 25, 1839,
AE. 54.
Epitaph: Blessed is the man that trusteth
In the Lord and whose hope the
Lord is.

In
Memory of
Mary.
Wife of
Amariah Ballou
who died
June 25, 1840
AE. 55
Epitaph

SECTION C
Section C8

ACKERT FAMILY MONUMENT

Lord M. Ackert - 1832 – 1902
Maria E. His Wife – 1827 - 1908
Belker W. Ackert - 1858 - 1900
Ethel L. Ackert - 1897 - 1897

VETERAN

EVERETT

Andrew Everett
Died Feb. 12, 1813 aged 72

VETERAN

Headstone significantly degraded
No inscription visible

Mary S., wife – d. Mar. 17, 1802 ae 58.

PERKINS

In Memory of
Mr. Daniel Perkins
who died
October 10th 1804
in the 37th year of
his age.

Caroline M.
Oct. 2, 1836
Mar. 23, 1838

South face— no inscription.

West face

John W. – Mar. 20, 1847 –
Jan. 5, 1867

Charles S. – Mar. 1854- age 22.

Section C9

BROWN

Celia Ann
daughter of Doct.
Jonas & Mrs. Ann
Brown who died
Aug. 12th 1826
aged 14 months.

LOOMIS

Rusel E.
son of
Lyman A. &
Susanna Loomis
Died
May 3, 1843
aged 6 yrs.

FRENCH

Son
John Burton French
Died
May 25, 1895
Aged 33.

Father
Sylvester B. French
Died
Nov. 11, 1884
Aged 63.

Mary E.
Daughter of
Sylvester & Sarah French
Died Dec. 3, 1853
(age set in cement. likely AE. 18.)

Headstone disintegrating

GILBERT

In

Memory of
Elijah Gilbert
who died

VETERAN

Aug. 6, 1829
in the 79 year
of his age

Epitaph: Unveil thy bosom faithful tomb.

Take this new treasure to thy trust
And give these sacred relicks room
To seek a slumber in the dust.

In

Memory of
Mary,
wife of
Elijah Gilbert

Who died March 22,
1840 AE 85.

Epitaph:

Find-A Grave provides the following:

Melinda (Apthorp) Gilbert

Born November 22, 1783 in Peru,

Died September 24, 1869 (85) in Peru.

A photo of Center Cemetery suggests Melinda's grave to be between Benson Gilbert and Mary Gilbert in Section B10. An initial probe of the area was unsuccessful in locating a headstone

In

Memory of
Benson Gilbert
who died

May 28, 1844
AE. 62.

Epitaph:

BROWN

Polly

wife of
Daniel Brown
died

Oct. 27, 1819
aged 42 years.

Section C10

HATHAWAY

In
Memory of
Polly G.
wife of
James D. Hathaway &
daughter of
John Abbe died
Jan. 1, 1839
AE.19.

Epitaph: Jesus can make a dying bed
 Feel like downy soft pillows are,
 While on his breast I lean my head,
 And breath my life out sweetly
 there

Mr. Seth Hatherway
Died March 24,
1820.
in his 51 year.

Epitaph: Come you
 ___ along and leave
 Remember that you soon must
 And be ___'d as well as I

Elizabeth
Wife of
Seth Hathaway
Died
Jan. 12, 1845:
Aged 69 years.
Epitaph:

OLDS

Almira,
Wife of
Reuben Olds
Died
Mar. 21, 1857
Aged 41 yrs.

ABBE

Mr. Rojer Abbe
Died Jan. 24,
1813

in the 46 year
of his age.
Epitaph: From Death's awrest
No age is free
Prepare yourself
And follow me.

FERGUSON

Elizabeth
wife of
John Ferguson
Died
Feb. 7, 1854
AE. 60

John Ferguson
Died
July 4, 1868:
Aged
77 years.

Section C11

THOMPSON

Hiram
Son of
Simeon & Sibbel
Thompson
Died Oct. 8th, 1814
in the 12th year of his
Age.

In
Memory of
Simeon Thompson
Esq. died Sept. 4th 1814
in the 48 year of
his age.
Epitaph: The rising morning can not inshur
That we shall end the day
For death stands ready at the door
To snatch our lives away

In
Memory of
Mr. Daniel Thompson
who departed this life

April 2nd, 1814

in the 84th Year of his age

Epitaph: And is the narrow bound our lone retreat

When life's last feverish pulse has ceased to beat

When tossed no more on Passion's turbid wave

We find a calm asylum in the Grave.

FERGUSON

Emeransia.

Entry Not included in 1948 book

Dau. Of

John & Elizabeth

Ferguson.

died Feb. 7. 1840

AE 5. mons 11 days

Double Stone

Lewis 1st

Died Sept. 18

1826 aged 16 mo.

& 10 da.

Lewis 2

died Feb. 21

1829 ae 13 mo.

& 15 da.

Sons of John & Elizabeth Ferguson

Epitaph: Sleep on sweet babe and take thy rest

Thou art early call'd God's time is best

Darius. Died

June 18, 1830: in the

8 year of his age

Sidney died

April 20, 1830:

aged 4 mo. & 7 days

Sons of John &

Elizabeth Ferguson

Epitaph:

RODGERS

In	Epitaph
<p>Memory of Edward Payson son of Joseph W. & Onnah Rodgers who died Jan 24, 1830</p>	

E. 18 mos. 19 days	
-----------------------	--

David Brainerd, son of
Joseph W. & Onnah
Rodgers
Died
Aug. 22, 1835
aet 4 yrs. & 8 mo.
Epitaph: Suffer little children
 come unto me for of such
 is the kingdom of heaven
 Matthew 19:14

MATTHEWS

James Matthews
Died
Oct. 12, 1835
AE. 25.
Epitaph: The sweet remembrance of the just
 Shall flourish when he sleeps in dust.

GEER

Erected to the Memory
of Mr. Calvin Geer.
who Died April 1st
1807 in the 26th
year of his age.
Epitaph: Hear lies our Friend
 No more shall Death
 Disturb his mind
 Or stop his breath

Limon Geer died March
20', 1818
in the 13' year of his age
and son of Mr. John and
Mrs. Onnah Geer.
Epitaph: I Give the parting hand
 to you
 Kind Father Mother dear
 To Brothers Sisters all
 adieu
 To follow me prepare

Headstone fragments encased in concrete. Using Find-A-Grave and an educated guess to assume this is David Ide's resting place.

Born March 26, 1764 Attleboro MA; Died July 28, 1830 Peru MA

MATTHEWS

Lois Matthews.

wife of

David Ide.

Died

July 5, 1845

aged 74.

Epitaph:

GEER

Horace

son of Ira &

Lucy Geer died

July 27, 1830:

Aged 11 mo.

& 6 days.

Epitaph:

Jewett.

son of Ira &

Lucy Geer.

died July 16, 1830

Aged 3 years 5

mo. & 2 days.

Epitaph:

Lucy A. Geer

Died

(Remainder set in concrete: March 3, 1857, Ae 20 yrs.)

In

Memory of

Mr. Ira Geer

who died Sept. 12

1836 ag'd 34 y'rs.

Epitaph: Far from affliction, toil and care,

The happy soul is fled

The breathless clay shall slumber

here.

Among the silent dead.

Lucy
Wife of
Mr. Ira Geer
who died May 26,
1854,
Ag'd 50 Yrs.
Epitaph: Do let me go, do let me go
I want to be with Christ
Then glory, glory sweet ____
And fell asleep in God

Section C12

BOTTUM

Austin Bottum
Died
Nov. 26, 1875
Aged 71 years, 1 mo.

Lucy Thompson
His wife
Died Oct. 10, 1875
aged 75 years, 5 mos.

STOWELL

In
Memory of Mr.
Nathaniel Stowell
died March 23rd, 1814, in
the 80th year of his Age.
Epitaph: There is rest
In Heaven.

VETERAN

In
Memory of
Lois, widow of
Nathaniel Stowell
who died August 6th
1824
Aet. 85 yrs.

BOTTUM

Alce,
wife of
W.R. Bottum
Died
Sept. 11, 1855.
Aged 30 y'rs.

In Memory of
Diantha.
wife of
Whitfield R.
Bottum, who died
June 1, 1841:
AE. 22.
Epitaph: Blessed are the dead
which die in the Lord.

The
Grave of
John M. Bottum
who died
April 15, 1841
AE. 29.

MAXWELL - STOWELL

In Memory of
Mr. Samuel Maxwell
who died
3rd Nov. A.D. 1803
Aged 23 yrs.

And an infant Son of Azel and
Abigail Stowell, died January
6th, 1805.

Epitaph:
Additional Text:

BOTTUM

Mary T.
wife of
Silas B. Bottum
died
May 18, 1842
AE. 29.

GEER

Welcome I. Geer.
Died
Nov. 4, 1857.
Aged 14 years.
Epitaph: God is our refuge and strength
A very present help in trouble

Milton Geer,
Died
Nov. 3, 1856,
Aged 29 years.
Epitaph: Therefore be ye also ready for in
such an hour as ye think not, the
son of man cometh

Emily O.
Daughter of
Peter &
Sally L. Geer,
Died
June 25, 1853
In the 9 year of her age.
Epitaph: A jewel for the Savior's crown

Almena
daughter of Peter & Sally L.
Geer Died Jan'y
27, 1842 In the
6 year of her age.
Epitaph: Of such is the kingdom of
heaven

SECTION D
Section D7

SHUTTLEWORTH

Edward K. Shuttleworth
July 7, 1907 – Dec 16, 1995
Born Providence, R.I.
His Wife
Florence O. Griffith
Nov 8, 1899 – May 20, 1991
Born Philadelphia, PA

ACKERT

Ethel I,
Dau. of
B.W. & Margaret
Ackert
Died
Aug. 20, 1897
AE. 5 mos.
Epitaph: Love budded on earth
To bloom in heaven.

Section D8

ZINK

Charles W. Zink
Died
May 30, 1889
AE. 56 yrs.

CROSIER

Susan - wife of John Crosier
Died --- Dec .8, 1843
ae 65.

John Crosier.
Died
Sept. 26, 1859.
Aged 81 yrs.

CROSHER

In Memory
of the children of
Andrew and Catherine
Crosher. Charlotte W. Crosher
died July 13th 1811 Lewis B.
Crosher died April 21, 1813
in the 3rd year of his age.

Epitaph: Stop my friends for hear you see
From Deaths arest no age is free

Charlotte aged 5 years

LOOMIS

Sarah Maria
Daughter
Of Calvin A. &
Abigail A. Loomis
Died Feb. 15, 1843
Aged 10 months
& 2 days.

BUTTS

Rufus M.
Son of
Johnathan &
Laura Butts
Died
Jan. 1, 1838

large circle of friends by _____
all of obedience and kindness and and
though in the morning of life, and full
of pleasing anticipations, she
unexpectedly was summoned
to the ____ of God.
Stay thoughtful reader
____ from me
That you are mortal

THOMPSON

Aug. 18, 1796
died Mrs. Dolly
Wife of Mr.
Artemas Thompson
Aged 25.
Epitaph: Let not the dead forgotten lie,
Lest (left) living men forget to die

In
Memory of
Mrs. Hepzibah
Thompson
Wife of Artemas
Thompson, Esqr.
who departed this life
February 25th 1826.
in the 56 year of her age.
Epitaph:

PIERCE / PIERCE

<u>Face</u>	Issac S. Pierce - 1802 - 1868 Eliza H. Thomson, His Wife — 1811— 1856
<u>Right side</u>	LELAND
<u>Back</u>	Thompson

HIBBEN

Eliza Hibben,
Wife of
Isaac S. Pierce.
daur of
Nathan Thomson,
Grand Daur
Rev. John Leland,
Died Oct. 16, 1856,

Aged 45y'rs.
Epitaph: Her virtue, kindness and nobility
still in memory remains

THOMPSON

Hipsy,
dau. of Nathan &
Polly Thompson
died
Jan. 28, 1808
aged 17 months.

Headstone missing
Entry included in 1948 book

Hipse, 2
dau. of
Nathan & Polly Thompson
died Nov. 27, 1827
Aged 19 years.

Nathan Thompson
Died
May 4, 1846
aged 70 years.

Section D10

STEVENS

In Memory of
Chloe Stevens wife
of William Stevens.
who died March 15,
1808 in the 37 year
of her age.

Epitaph: Farewell, bright soul, a short farewell,
Till we shall meet again above;
In the sweet groves where pleasures
dwell,
And trees of life bears fruits of love.

Mr. William Stevens
died Feb. 5th 1794
in the 62 year
of his age.

Mercy Stevens
died
Sept. 18, 1820,
aged 93 years.

Mr. Oliver Stevens
died June 11, 1794
in the 33 year
of his age.

VETERAN

LELAND

Here
Are inter'd the bodies of
Mrs. Lydia, Mother of Rev.
J. Leland who died Sep. 3,
1794 Aet. 78. Mrs. Hepzibah
his amiable wife who died
June 5th 1805 Aet.58 Mr. Levi
Leland his son Aug. 28, 1794
Aet. 19
Epitaph: No love no friends no prayers
No tears could save ____
This lovely youth

LELAND

In memory of
Alatheia
wife of
Rev. John Leland
who died
Sept. 12, 1815
AE. 52.

THOMPSON

Polly
Wife of
Nathan Thompson
Died
Oct. 21, 1863
AE. 78 .

BREWSTER

In
Memory of
Rev. Joseph M. Brewster
who died
Dec. 29. 1833.
aet 35.
Epitaph:

In
Memory of

Mrs. Mary Freeland Brewster
consort of
Rev. Joseph Marsh Brewster
who died
March 5, 1827
Aet 24
Epitaph: _____ who die in the Lord

ABBE

In
Memory of
Miss Anna Abbe
who died
Nov. 12, 1829
Aet 30 years & 3 mo.
Epitaph: The world is ___ full of ___
 With cure and trouble
 But they are blest _____
 With Christ _____

Section D11

THOMPSON

Harriet Thompson
Died July 8, 1886
Aged 78 yrs. 1 mo.

ROCKWELL

Ida (Rockwell?) – No information on stone

Jennie (Rockwell?) – No information on stone

This Monument is erected
By Majr Amasa Rockwell
in memory of his wife Mrs.
Olive Rockwell
who died Feby 5, 1801 in
the 36th year of her age.
Epitaph: Her humble virtue stealing to the dust
 Heeds not our loss or monumental bust
 To name her virtues ill befit my grief
 What was my bliss can now give no relief
 A husband mourns – the rest let friends
 Fame – spread her worth – a husband knew
 It well

BARNABEE / WHITE

Double Stone

Harriet N.
daughter of
James &
Delight Barnabee
died
Sept. 22, 1818
Aged 15 months

Dwight
son of
John &
Delight White
died
March 21, 1830
Aged 4 years

Section D12

BARNABEE

In memory of
Chandler Barnabee
who died
March 14th 1816
in the 55 year of his age
also his Children
J.A.B. died May 22nd 1819,
aged 37.
J. B. died 27th 1810 ae 22yrs.
O. B. died April 13th 1805 aged 3 yrs.
Three infants
F.B. died 8th, 1814 aged 19.
Epitaph: ___ friends will _____ -
And with a sigh _____
Stand getting _____
That will be _____

PIERCE / PEIRCE

Mrs. Mary Pierce
Consort of
Mr. Eli Pierce
died September 17th
1813 aged 40 yrs.
Epitaph: _____ just
The sweet remembrance of the
In dust
Shall flourish when they sleep

Eli Peirce
Died
July 13, 1868
Aged 95 yrs.

VETERAN

MEACHAM

Ambrose Meacham
Died

Correct location of headstone remains to be
determined

Nov. 25, 1887
Age 83 yrs.

Electa.
His wife
Died
Jan. 15, 1889
Age 84 years.

SECTION E
Section E8

OAKES

Gerald F. Oakes, Sr.
Jan. 16, 1954
Wife
Betty J. Ellsworth
Aug. 11, 1957 – Jan 9, 2017
Loving Parents and Grandparents

EMERSON

Charles G. Emerson
1917 - 1992

Madeline D. Emerson
1921 - 2013

WEEKS

WEEKS

Pearl E.
1-26-1913
8-25-1986

Arthur W.
8-23-1914
6-24-2012

Section E9

RICHARDS

In Memory of
Mrs. Bethiah, wife of
Col. William Richards, who died
June 4, 1794
in the 32 year of her age.
Epitaph: Her Life was Purity
her End was Peace

THOMPSON – Large stone, face down. Footstone shows ‘A.E.T.’ Inscription may read:
In Memory of Aaron E., Son of Artemas Thompson. Esq.,
who died July 25, 1823 in the
18 yr. of his age.

Sherman 2nd
Son of Art. &
Dolly Thompson
died May 6,
1796; aged
3 months.

Sherman, Son of
Art. & Dolly Thomp
Son, died June 2,
1795 aged 15 months.

Lucy, dau't of
Art. & Dolly Thomp
son died Dec. 7.
1792; aged
25 days.

STOWELL

Emily
Wife of
Milo Stowell
Died
Aug. 20, 1863
Aged 46.

BOWEN

Emily M. Bowen,
A resident of Ohio
Died
Sept. 22, 1863
Aged 25 y's.
Epitaph: Saved by grace

GUILD

Loren Guild
God Called and Loren answered
1920 – 1976

LITTLE

Capt.
Ezekiel Little
Died Mar. 25,
1789
Aged (76 – 77; Remainer set in cement)

VETERAN

Section E10

STEVENS

In Memory of
Chester Stevens
he died May
18, 1776,
Aged 16 years

First burial in Center Cemetery

BENTON

In
Memory of
HANNAH,
wife of
Jacob Benton
who died
Aug. 21, 1825.
Aet. 65.

PARTRIDGE

Died
Aug. 11, 1826
Mary C.
wife of
Asa B. Partridge
aged 29.

TUTTLE

David M.
Son of
John M. & Sarah
Tuttle
Died Sept. 10, 1840
AE 1 year.

Also an infant son
died Mar. 9, 1838
aged 3 days.

Section E11

TUTTLE

In Memory of
Col. David Tuttle
who died
April 1, 1838,
aged 55 years
Epitaph: His soul _____
To _____
To _____
And dwell in the kingdom _____

VETERAN

THOMPSON

Mr.

Peter Thompson
died Jan. 25, 1801:
in the 66 year
of his age.

VETERAN

Epitaph: Behold and see as you pass by
As you are now so once was I
As I am now, so you must be
Therefore prepare to follow me

Mrs. Elizabeth Thompson
Consort of Mr. Peter
Thompson
Died May 2th
1810 in the 70 year
of her age.

Epitaph: My flesh shall slumber in
the ground
Till the last trumpet's joyful
sound
Then burst the chain in
sweet surprise
And in my Savior's image
rise

Section E12

ROCKWELL

Mrs. Eunice
wife of
Elisha Rockwell
Died
Nov. 8, 1813

Entry included in 1948 book
Headstone not in cemetery
May be buried with husband in
Hinsdale Cemetery since her
info is on their shared
headstone

WATKINS

Dea. Zecharia Watkins
Died
June 24, 1826.
Aged 86 years.

VETERAN

Abigail Watkins
Died
May 18, 1826.
Aged 90 years

THOMAS

Mrs. Eliza.
wife of
Mr. William Thomas
died March 4, 1826:
Aged 18 years.

FOOT

In
Memory of Mr.
David Foot
Who departed this Life
June the 13th, 1806 in the
70th Year of his age.

VETERAN

STOWELL

Rosetta M.
Wife of
Francis Loveland
And
Oldest daughter of
Dea. John M. & Olive M
Stowell
Died
Sept. 19, 1867
AE. 26 Y's
Epitaph: At rest in the bosom of her Savior

Entry Not included in 1948 book

Dea. John M. Stowell
Born
Sept. 16, 1814
Died
July 10, 1894
Epitaph: _____
when I awake in the
likeness."

Entry Not included in 1948 book

(Stone broken along first line of epitaph)

Lucelia M.
Daughter of
John M. & Olive M.
Stowell
Died
July 4, 1862
Aged 15 yrs.
Epitaph: Daughter, sister. we come to you

Olive M.
wife of
John M. Stowell,
Died
May 22, 1866.
Aged 45 y'rs.

Epitaph: Mother and daughter have met
where parting is no more.

Sarah Elizabeth, Wife of Dea. John M. Stowell. Died Nov. 17. 1886. Aged 53 y'rs 6 mo's. Epitaph: Safe in the bosom of Jesus Our Mother has pillowed her head	Entry included in 1948 book Headstone and base had been buried to the left of Olive M. Stowell. 'S.E.S.' footstone returned to grave
---	---

Mary Elizabeth Daughter of John M. & Sarah E. Stowell Died Feb. 25, 1891. Aged 20 y's 10 mo, & 7 days.	Entry included in 1948 book. Headstone fragment cemented in base excavated and set next to Sarah Eizabeth.
--	--

Harriet B.
Widow of
James C. Stowell
Died
March 20, 1892
Aged 92 y's.

James C. Stowell
Died
October 24, 1886
Aged 85 years.
Epitaph:

Our
Eddie
Died
Mar. 15, 1865
Aged 3 yrs.

Susan A.
Daughter of
Harvey & Margarete
Stowell
Died

Oct. 20, 1843
in the 25 year
of her age.
Epitaph: Through Gods abounding grace
Her life and death were pure

Hiram
Son of
Mr. Harvey &
Mrs. Margret
Stowell, died
July 15th 1826.
Aged. 24 years.

In Memory of
Margret,
wife of
Harvey Stowell
who died Apl. 25th
1824
aged 45 years.
Epitaph: She was my guide my friend my

Love grew with every waning _____
moon
Had heaven a length of years
delayed her _____
_____ had thought her call.d
too soon

Harvey Stowell
Died
Apr. 29, 1857.
Aged 82 y'rs.
Epitaph: Precious in the sight of the Lord
Is the death of his saints

Jerusha Herrick,
wife of
Harvey Stowell.
Died
Nov. 5. 1883.
in the 97th year of
her age.

Epitaph: She hath done what she could

HASKELL

Delesa

Dau. of

Zechariah & Unity

HASKELL

Died Oct. 15, 1823

aged 2 yrs. 4 mos. (last line is below ground)

Zechariah.

Son of

Zechariah & Unity

HASKELL

died July 6, 1830

aged 6 yrs. 8 mos.

Hermon

Son of

Zechariah & Unity

Haskell

Died Aug. 20, 1835.

Aged 9 yrs. 3 mo.

Zechariah Haskell

was thrown from

his wagon and killed

Aug. 10, 1860

Aged 76 y' s 9 mo.

Epitaph: The gift of God is eternal life

SECTION F

Section F6

BRADSHAW

Betsey M.

Wife of

William Bradshaw

April 23, 1843

August 17, 1895

BARLOW

Myra Elizabeth Barlow

April 16, 1889 - May 15, 1892

Epitaph:

STOWELL

Charles I. Stowell

1853 – 1932

Minnie A.
Wife of
Charles I. Stowell
Died
Apr. 15, 1896
AE. 29.
Epitaph:

Irving (Stowell)
Feb. 17, 1891
Sept. 8, 1913
No graves in this section

Section F7

Section F8

PEIRCE

Alvan B. Peirce.
Died
Sept. 19. 1851
AE 25 Y's.

Mother
Polly,
Wife of
Capt. Isaac Peirce
Died
Sept. 1, 1866
AE. 76.

Capt. Isaac Peirce
Died
Apr. 28, 1867
AE. 82.

Headstone disintegrating

Section F9

PIERCE

Mrs. Lydia K.
wife of
Shadrach Pierce
Died
Sept. 1, 1831
aged 36

PEIRCE

Here lies in early years bereft of life,
The best of mothers and the kindest wife

Mrs. Tamerson, wife of
Mr. Shadrach Peirce
Died March 1st, 1817
aged 33 years.

Epitaph: Death is a debt to which I have paid and _____
(so must you.)

PIERCE

Shadrack Pierce.

Died

Mar. 24. 1832

Aged 50 y's.

Epitaph: The greatest Natural Architect
in the County.

STOWELL

Mother on front— inscription on back

Asenath,

Wife of

Cyrus Stowell, Esq.

Died March 21. 1869

Aged 90 years.

Epitaph: "Blessed are the dead that
die in the Lord"

Father on front;

Inscription on back

Cyrus Stowell, Esq.

Died

Feb. 13, 1859

Aged 91 yrs. 4 mos.

& 14 days

Epitaph: Uniting in his character, the enli
ghtened piety of the christian, the
firmness of the magistrate, the confi
ding affection of a husband, the
tender solicitude of a father, and the
sincerity of a friend.
His end was peace.

In Memory of
Mrs. Eunice Stowell
Wife of
Cyrus Stowell, Esq.
Who died
Nov. 10, 1805
Aged 49.

Headstone disintegrating

Hiram
Son of
Cyrus Stowell
Died April 18
1802 aged 15 mos

THERE IS REST IN HEAVEN

In Memory of
Nathl E. Stowell
Who died
March 18, 1831
AE. 19.

Section F10

LITTLE

In Memory of
Lucy Little who
died Feb. 11, 1808.
aged 23 years.

In Memory of
Mifs Molly Little,
who died Aug. 21st
1803, in the 26
year of her age.

Epitaph: Unveil thy bosom faithful tomb.
Take this new treasure to thy truft
And give these sacred relicks room
To seek a slumber in the duft.

Mifs Anne Little
Died March 12, 1801
aged 20 years.

Epitaph: The faireft face is buried in
the duft
Prepare for Death, for
follow me you muft

PEIRCE

In Memory of
Mrs. Lydia Peirce
who departed this
Life October 23rd,
1800 in the
20th year
of her
Age.

Epitaph: Life Eternity
 How How
 Short Long

This Monument is

Dedicated to the Memory
of Eunice Peirce
who was born A. Oct.
D. 1750 died Feb. 10,
1826 the relict of Ebenezer Peirce, Esq.
who died at Marietta,
Ohio A. August D. 1802
aged 58 years.
Epitaph: By faith in Christ
She welcom'd death

Chloe Ann
Daughter of
Ebenezer Pierce
Electa Pierce
Died
Feb 12, 1838
AE. 15.

Aaron Peirce,
son of
Ebenezer & Electa
Pierce,
Died
Nov. 7, 1851
Aged 32.

PIERCE FAMILY MONUMENT

East face

Ebenezer Pierce
Died
July 15, 1865
Aged 76
Epitaph:

Personal Marker - Father

South face

Electa
Wife of
Ebenezer Pierce
Died
May 15, 1872
Aged 78 yrs.

Personal Marker - Mother

WATKINS

James Watkins.
Died
Oct. 10, 1845.
aged 64 years.

VETERAN

Dorcas
Wife of
James Watkins
Died
Sept. 23, 1860
Aged 77 years.
No graves in this section

Section F11

Section F12

FRISSELL

Albert.
Son of Wm. &
Ruth Frissell.
He was killed by
the fall of a tree.
March 10, 1828.
aged 22 yrs.
Epitaph: In the midst of life is death

Ebenezer
Son of Wm. &
Ruth Frissell
died Aug. 14.
1808
aged 10 yrs. & 5 mos.

In memory of
William Frissell
Junr. who departed this life
April 21, 1811:
in the 41st year of his age.
Epitaph: This stone stands here to show the place
Where his dust lies not that he was
When saints arise that day will show
The part he acted here below

In
memory of
John Frissell
Who died April
4, 1809 in the
25 year of his age.

Epitaph:
This mortal body _____
Not _____
When Jesus calls _____

In
memory of
Walter Frissell, who
died June 21, 1801
in the 20 year
of his age.

Epitaph: Whom neither youth nor worth
Nor friends could save
From the relentless
Bondage of the grave

In memory of
William Frissell, Esq.
who died
December 25, 1824
in the 86 year
of his age.

VETERAN

In memory of
Judith.
wife of
Wm. Frissell, Esq.
who died
Aug. 15, 1831
in the 90 year
of her age.

Lemuel Frissell
Died Aug. 1, 1863
Aged 83 yrs.

VETERAN

Charlotte
His Wife

Died Oct. 8, 1859
Aged 78 yrs.
Epitaph: He giveth his beloved sleep

WATKINS

Zachariah Watkins
Died
August 3, 1852.
Aged 74 yrs.

FRISSELL

Martha Emeline.
wife of
Franklin Frissell
Died
May 24, 1857.
Aged 39 yrs.
8 mos. & 19 days.
Epitaph: Se_ not for God look her

Franklin Frissell
Died
Oct. 27, 1862
Aged 46 yrs.

STOWELL

William W. VETERAN
Son of James C. &
Harriet B. Stowell
Died
at Baton Rouge, La.
July 1, 1863
Aged 20 y'rs. 1 mo.
& 21 d's.
Member of Co. C. 49th Reg. Mass. Vol.
Buried here May 1864
Epitaph: Our dear boy gave his life for his
country
His father's hope— his mother's joy
Died that freedom might not die.

SECTION G

Section G8

WINDOLOSKI

Tommy R
April 19, 1971 – April 9, 2017

BENNETT

Kimberly L Bennett

Aug 15, 1972

BUNNELL

Mickey J. Bunnell
Oct. 3, 1950 – Jan. 7, 2017

Devon C. Bunnell
October 4, 1980 – July 19, 2008

DARBY

Shannon Marie
Oct. 3, 1980 – Dec 1, 1999
Epitaph: Forever in our hearts

Section G9

WETMORE

William Wetmore
Died
June 16, 1859
Aged 76 y'rs.
Epitaph: Blessed is he that considereth
the poor
The Lord will preserve him

BACON

Joseph Bacon,
Died
June 3, 1852
Aged 90.
Epitaph: Christ is my star.

VETERAN

The Grave of
Mrs. Lucy,
wife of
Joseph Bacon
Who died
Apr. 13, 1840
Aged 76 years.
Epitaph:

In Memory of
Joseph Bacon, Jr.
Son of
Joseph &
Lucy Bacon
who died
Oct. 14, 1828:

aged 33 years.

Lucy Bacon

Died

Dec. 28, 1853

Aged 55.

Epitaph: There is rest in heaven

Section G10

STOWELL

Sarah B.

Wife of

Franklin Stowell.

Died

Nov. 13. 1878 .

Aged 69 y'rs.

Epitaph: "Blessed are the peace makers"

Mrs. Lydia

wife of

Franklin Stowell

died

March 28, 1835

AE 30.

Epitaph: The Lord

Franklin Stowell

Died

March 20. 1889.

Aged 82.

Epitaph: Faithful unto death

BOWEN

In Memory of
Elizabeth.
wife of
Christopher Bowen
who died Oct. 17, 1813
aged 63 yrs.

Epitaph:
May angels with their guardian wings
This deary tomb o'er spread
And guard untill the close of time
This mansion of the dead.

In Memory
of Mr.
Christopher Bowen
Who Nov. 29
1836.
Aged 86 years.

VETERAN

This lovely

William Bowen
Died
Aug. 16, 1868
Aged 87 yrs.
2 ms. & 16 days

PERRY

Betsey Perry,
Wife of
William Bowen
Died
Dec. 28, 1879
Aged 85 yrs.

BOWEN

The Grave of Monica Aspasia
Wife of Sylvester S. Bowen
Died July 1, 1875
Aged 58 yrs.

Entry included in 1948 book
Burial is in Hinsdale Cemetery

Sidney Sherwood
Son of Sylvester S. & Monica A. Bowen
who died Oct. 8, 1841 aged 2 years.

Entry included in 1948 book
Burial is in Hinsdale Cemetery

Section G12

THOMPSON FAMILY MONUMENT (North monument)

East Face:

Sarah
wife of Dea. Joseph Clark
died Dec. 27, 1816
aged 75 yrs.

(On Base) Erected by his son John Thompson

North Face:

Amherst Thompson
died May 21, 1857
aged 95 yrs.

VETERAN

Sarah
his wife
died Jan. 15, 1852
aged 85 yrs.

South Face:

Joseph Thompson
died in Ohio 1795

VETERAN

Abigail
his wife
died Sept. 26, 1817
aged 87 yrs.

Personal Markers for Abigail, Sarah, Sarah and Amherst
THOMPSON FAMILY MONUMENT (south monument)

East Face

Joseph Thompson
Died Dec. 19, 1827
Aged 38

Clark P.
Son of Joseph & Hannah
Thompson
Died Feb. 7, 1838.
Aged 20

(On Base) Erected by D.W.C. Thompson

South Face

Smith Thompson
Died May 26, 1885
Aged 84

Hannah,
His Wife, died Nov. 5, 1879.
Aged 83

Joseph A.
Son of Smith & Hannah
Thompson
Died Jan. 9, 1831
Aged 3 weeks

Personal Markers for JT, CPT and JAT. A fourth personal marker is broken and another is missing

TRACY

In
Memory of
electa TRACY
daughter to
nathaniel and

Susanna Tracy
who died
August 2d, 1794
aged 2 years &
7 months

SECTION H
Section H9

STOWELL

Almira R.
daughter of
Joseph C. & Jane C. Stowell
(Died Feb. 27, 1846 at 6 mos.)

CADY

Lewis Cady
Died
Jan. 6, 1879
Aged 43 yrs.

Cyrine,
Wife of
Lewis Cady
Died
Aug. 25, 1866
Aged 24 yrs. &
10 mos.
Epitaph: _____ what _____

5 Personal Markers – Not included in Index

BB
SCS
CAB
LC (Lewis Cady)
CC (Cyrine Cady)

LATHROP

John S. Lathrop
Died
Dec. 20th 1848
Aged 25 years
9 months.

HASKELL

Mary Haskell
Died Dec. 13. AD. 1849
Aged 86 yrs. & 23 days.
Epitaph: Beneath _____ -

My _____ rest
My Spirit _____

Roger Haskell
Died
Apr. 6, 1847
Aged 94 years
Epitaph: I have set the Lord always before me
My flesh also shall rest in hope.

VETERAN

BROWN

George L.
son of
Elijah &
Harriet Brown
died
Feb. 22. 1829.
aged 7 months.

Also
two Infant children

Sally,
Wife of
Solomon Brown
Died
Dec. 24, 1863
Aged 92yrs.
Epitaph: Our suffering here will make us meet
To land before the throne complete
Though in the ___ we are___
We shall come for the ___ at last

Solomon Brown
Died Aug. 12, 1856
Aged 82 yrs.
Epitaph:

Section H10

FRARY

Luman W. Frary
Oct. 25, 1850
Apr. 16, 1916

Lena E.

Wife of
Luman W. Frary
Died Feb. 22, 1914
AE. 70 yrs. 11 mos. 2 ds.

BEALS

Arvildia A.
Daughter of
Judson &
Mary Beals
Died
May 29, 1853
Aged 5 yrs.
5 mo. 5 days.
Epitaph: _____

Stone is behind a neighboring stone

ROSS

Sarah E. Ross
Died
Aug. 12, 1884
Aged 64 years.

Mother
Alce,
Wife of
Lemuel Ross.
Died
Jan. 3, 1873
Aged 79

Father
Lemuel Ross
Died
Nov. 9, 1863
Aged 80.

Lucy A.
daughter of
Lemuel & Alce
Ross, died
May 6, 1838:

aged 4 years
& 5 days.

FOOT

An
Infant Son of
Harlow &
Euretta Foot

BROWN

Jane,
Dau. of
John & Judith Brown
Died Mar. 1, 1816
Aged 10 days.

Henry D.
Son of
John & Sarah B. Brown
Died Mar. 13, 1850.
Aged 12 yrs.

Sarah.
wife of
John Brown
died
Aug. 19. 1840.
aged 26 years.

Epitaph: Her last words

My friend weep not for me
In the agony of death
I am happy as happy can be
And soon shall be triumphantly in
eternity

S.D. Marble Pitts

BLACKMAN

Betsey,
Wife of
Nathaniel Blackman
Died
June 22, 1866.
Aged 93.
Epitaph:

Nathaniel Blackman
Died
Jan. 8th 1846 .
Aged 80 yrs.

NASH

Betsey.
daughter of
E.T. & C.F. Nash
Died
Sept. 26. 1848.
Aged 10 years.

Jonathan
son of Edward T.
Nash, died
Oct. 18, 1837
aged 7 mo's.

In Memory of
Mrs. Betsey Nash
Wife of
Mr. Edward T. Nash
Who died April 5,
1837
Aged 31 yrs.
Epitaph:

Jonathan Alvan
son of
J. & E. Nash.
died
March 16, 1829.
AEt. 4 months.

In Memory of
Jonathan Nash, Jun.
who died
Apr. 15, 1829
AEt. 32 yrs.

Stone disintegrating

In
Memory of
Oliver Nash
Who died
Dec. 17, 1853,
Aged 59 yrs.

Epitaph: He Sleeps not without hope

FRISSELL

Susan W.,
Daughter of
Wm. & Chloe Ann
Frissell
died Sept. 9,
1841
Aged 1 yr. 7 mo.

EMMONS

Laura Emmons
Wife of
Augustus C. Frissell
July 3. 1810.
Sept. 18, 1898
Epitaph: The busy hands are now at rest.

FRISSELL

Capt.
Augustus C. Frissell
Died
Nov. 14, 185.
Aged 45 years.
Epitaph: Trust in God

VETERAN

Hannah,
Wife of
Thomas Frissell
Died Apr. 3, 1849.
Aged 65 Years.
Epitaph: Seek the Lord while he may be
found, Call upon him while he is
near.

Capt. Thomas Frissell,
Died
Nov. 21. 1835
Aged 62 years.
Epitaph: It is not in man that walketh
to direct his steps.

VETERAN

W.C.T.U.
Seraph Frissell M.D.
1840 - 1915
Graduate

Mt. Holyoke Seminar 1869
Michigan University 1876.
Removed from Hinsdale 1943

Section H11

BALLOU

Eunice Marette
Wife of
Lyman D. Ballou.
Died
Aug. 7. 1863.
Aged 37 yrs.

Willie D.
Died July 20, 1855.
aged 3 ms. 2 ds.

Nellie M.
(Remainder set in base:
Died Sept. 28, 1857
Aged 23 days.
Children of L.D. & E.M. Ballou)

GOLDTHWAIT

Warner,
Son of E. & E.M.
Goldthwait
Died
Aug. 15, 1815
AE. 7 mo.

Eliza M.
Wife of
Elias Goldthwait.
Died
Aug. 26, 1870.
Aged 64 y'rs.
Epitaph:

Elias Goldthwait
Died
Oct. 3, 1895.
Aged 92 yrs.
Epitaph: Gone Home

WISNER

Mary Ann Wisner

was born at
Dwight, Arkansas.
died In Peru
Oct. 27. 1845.
AE. 20.

Section H12

FRISSELL

In memory of
Mrs. Sabra
Consort of
Mr. Amasa Frissell
who died
July 4, 1824
Aged 52 yrs.

Zerviah,
wife of
Amasa Frissell.
died
July 13. 1834.
aged 50.

Abigail,
wife of
Amasa Frissell
Died
Nov.9, 1845,
AE. 58

Amasa Frissell
Died
April 1, 1847 (year from Peru Vital Records)
Aged 78 years

Socrates Frissell
Aug. 23, 1875.
Aged 82 years.

VETERAN

Mary S. Frissell
Oct. 10, 1875.
Aged 82 years

BOURE

Alexandrin Boure
Died

Oct. 18. 1907
Age 30 Years

SECTION I
Section I9

BROWN FAMILY MONUMENT

East face: Urial Brown 1815 – 1888

Martha B., His Wife - 1820 – 1904

North face: Charles S. Brown – 1863 – 1878
Sarah I. Brown – 1815 – 1876

South face: Clara A. Brown – 1852 – 1854

STUKEY

Sibyl C. Stukey – 1847 – 1871

BROWN

Sara I.
wife of
Murray E. Brown
Died
March 14, 1876,
Aged 31.
Epitaph: Gone but not forgotten

Bessie C.
Daughter of
Murray E. &
Sarah I. Brown
Died
Sept 24, 1873
Aged 3 y'rs. 8 m's.
Epitaph: A Bud on earth
A blossom in heaven

BEERY

Baby
Katie Marie Beery
April 17, 1985

Section I10

PARSONS

Lydia K.
daughter of
Thomas & Maria Parsons
Died

Sept. 2, 1855
Aged 13 yrs.

Thomas Parsons,
Died
Nov. 14. 1865.
Aged 62 y'rs.

SPAULDING

Lovice M.
Wife of
D.W. Spaulding
Died
Sept. 25, 1866
Aged 43 yrs.

KNIGHT FAMILY MONUMENT

East — Ruby H., Wife of Rev. Joseph Knight
Died Dec. 5, 1849 aged 54 yrs.

North — Harriet, Wife of Rev. Joseph Knight
Died April 19, 1879 aged 87 yrs.

South — Rev. Joseph Knight
Born in Monson, Mass. - 1788
Died in Stafford, Ct. , — 1860
The Pastor of this Church for 19 years
and a preacher of Gospel 46 years.

Mary Evelyn — no other inscription
(Born Sept. 27, 1849, Hinsdale MA
Died March 11, 1850, Hinsdale MA
Daughter of Joseph Knight and Mary Pratt Frissell Knight)

Arthur Leroy — no other inscription
(Born Oct 19, 1850, Berkshire, MA
Died Dec 10, 1855, Peru, MA
Son of Joseph Knight and Mary Pratt Frissell Knight)

MORRISON / SHEA

Wallace G. Morrison
9-24-1911 – 12-22-1981
His Wife
Mary V. Shea
6-2-1911 – 1-15-1987

VETERAN

BOLIO

Arnold R. Bolio
June 24, 1924 – April 8, 1995

VETERAN

ALLGAIER

His wife
Carretta H. Allgaier
November 24, 1926 – May 8, 2021

GUY

Roland A Guy
July 5, 1928
Oct. 3, 1994

VETERAN

Cossette T. Guy
July 4, 1928
Aug. 21, 2015

David M.
Guy Sr.
April 29, 1953
Oct. 21, 2021
Epitaph: Laughing with Angels

Judy Vogel
Guy
October 7, 1965
Epitaph: Together Forever

Section I11

KNICKERBOCKER

Margret,
wife of
Wm. Knickerbocker
Died
Dec. 20, 1886
Aged 71 y'rs.
Epitaph:

STONE

SISTER
Mary E.,
wife of Ward N. Stone
Died Nov. 10, 1881
ae 54 yrs. 4 mos.
Epitaph: Gone Home

FITCH

Almeda,

Wife of
William Fitch
Died
Feb. 15, 1871
Aged 88 years.

Small personal stones for Freddy, Seraph & Walter

Julia I., Daughter of
Milton & Mary H. Fitch
Died July 11, 1876
aged 21 yrs.
Freddy R., aged 2 yrs.
Died Aug. 15, 1876
Seraph Aged 4 yrs.
Died Feb. 14, 1876
Walter H. Aged 9 mo.
Died Feb. 22, 1881
Children of Milton &
Catherine C. Fitch

HASKELL

Lucy A.
Wife of Allen Haskell
Sept. 19, 1883
Age 73 yrs

Allen Haskell
Died
Jan. 7, 1890
Age
86 yrs. 7 mo.

George H. Haskell
1844 – 1914

Front Little
Bertha
Precious Jewel
Back: Died
Mar. 18, 1883
AE. 5 yrs. 9 mo.

(possibly a Haskell, parents unknown)

Hannah E. Haskell
Wife of
Cullen B. Watkins
1893 - 1931

Entry not included in 1948 book

Cullen B. Watkins
Died March 9, 1877
Aged 29 yrs.

"Dear Papa is at rest."

Cleopatra,
Wife of
Zenas Watkins
Died Nov. 25. 1873:
Aged 63 years.

Zenas Watkins
Died
Jan. 30, 1875:
Aged 71 years.

MONGON

Hellener,
dau. of
Bruno & Julia
Mongon
Died Jan. 19, 1865,
Aged 9y's 8 m's.

UNKNOWN – Footstone 'S.C.'

Section I12

GEER

Front: Our little
Charlie
Aged 4 y'rs.
1 mo. 10ds.
Epitaph: Safe with the Savior
Back: Son of
Jewett H. & Mary C.
Geer
Died Mar. 6. 1881.

STOWELL FAMILY MONUMENT

East face: Dr. Ashley Livingstone
Son of Austin & Hyla Stowell
Died at St. John's Hospital
Brooklyn, N.Y.
Oct. 3, 1891
Aged 25 yrs. 8 mos.
Epitaph:

North face: Hyla Cleopatra Watkins
Wife of Austin Stowell
Born March 14, 1835
Died Oct 15 1908
Epitaph:

Entry not included in 1948 book

South face: Austin Stowell
Born Dec. 4, 1832
Died Apr. 29, 1895
Aged 62 yrs.

WATKINS FAMILY MONUMENT

East face: Samuel Watkins 1772 – 1854

Patty Cody
His Wife
1774 – 1868

Daughters
Dolly 1799 – 1877

Julia 1807 – 1881

West face: Samuel T. Watkins
1812- 1887

Cordellia Fuller
His wife
1816 – 1897

Children
Howard 1846 – 1866

Clara 1856 – 1859

KRUPSKI / SAKOWICZ / THOMAS

Family Headstone

Francis E 1946 - 1979

His Wife, Doreen Sakowicz 1954 -

Stanley F 1919 – Father – 2005

Nellie A. Thomas – 1919 – Mother – 2011

Flat markers

Francis E. Krupski **VETERAN**
SSGT US ARMY
VIETNAM
Dec 19, 1946 - Sep 6, 1979

Stanley F Krupski **VETERAN**
SGT US ARMY AIR FORCES
World War II
Feb 3 1919 - Oct 19 2005
Nellie A. Thomas
Wife of Stanley F Krupski
Sep 19 1919 - May 23 2011

Post Script:

PELTON – Included in 1948 book

Remains & the stone removed to Hinsdale Cemetery before 1899

Mother

Laura T., Wife of Alson H. Pelton

Died Oct. 11, 1866 aged 60 yrs.

NORTH (PIERCE) CEMETERY – PIERCE ROAD

FROM THE 1948 TOMBSTONE INSCRIPTION BOOK: This cemetery is on the road from Peru to East Windsor, about a half mile from the old stone school— house, built in 1841, and about three miles from the Peru Meetinghouse. This is sometimes called the Pierce Cemetery. It is in a good state of repair and burials are still made there.

2023: This cemetery is included in the Massachusetts Cultural Resource Information System (MACRIS) database. The approximate location of the cemetery is 42.4607-73.008152. The elevation of this cemetery is 1889ft / 576m.

The mapping of North Cemetery was undertaken as a Boy Scouts of America Eagle rank project in 2006. This 2023 version of the Tombstone Inscription Book uses the Boy Scout project numbering system and has added new numbers for new graves and any which were not originally included. The detailed mapping of graves is included in the appendix on pages 125 and 126 to aid in locating specific headstones. The general shape of the cemetery follows:

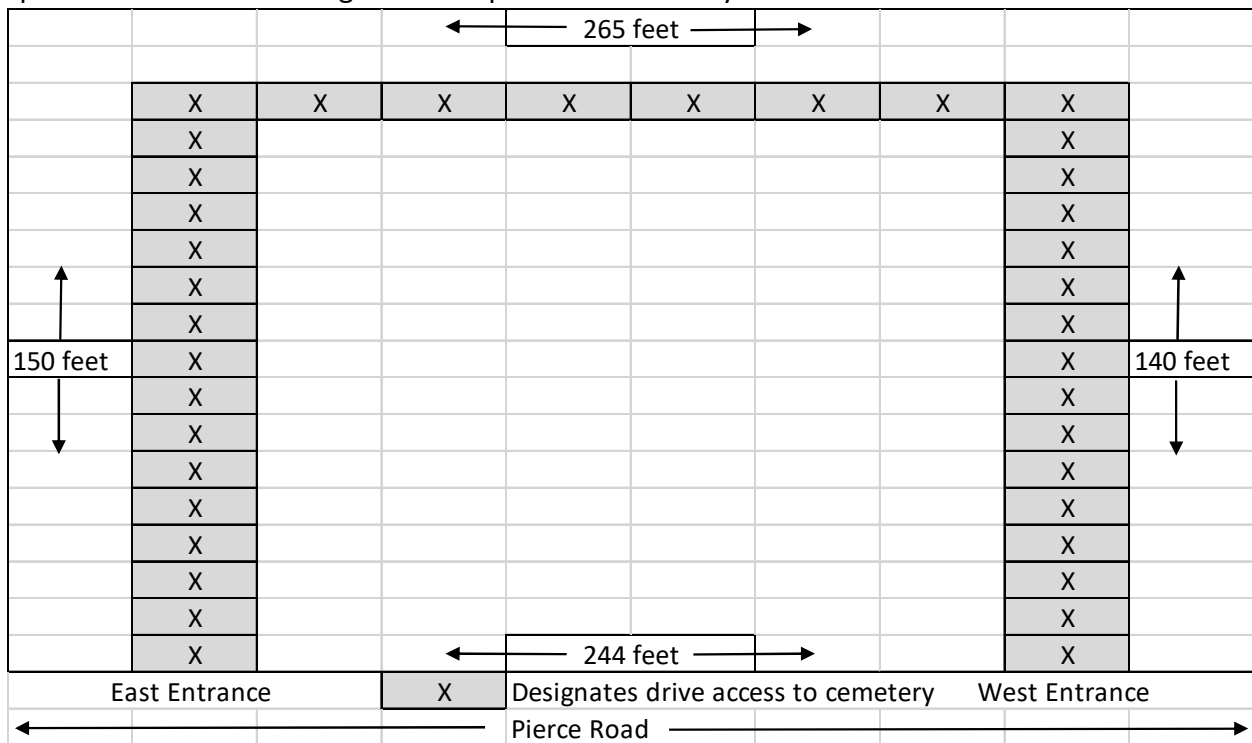

100

Kenneth F. Torrey
 Aug 21, 1920
 Aug 4, 2003

Marion I Harwood

Kenneth F. Torrey **VETERAN**
 CPL US ARMY
 World War II
 Aug 21 1920 Aug 4 2003

- Sept 15, 1924
Dec. 31, 2016
- 227 Bradford Torrey
November 2, 1944 – August 31, 2023
- 101 1941 Roah A. Pierce 1965
Children
1959 Wilfred W. Pierce 1965
1961 Roberta A. Pierce 1965
- 217 TORREY
Timothy T.
Sept. 26 1971 July 1 2013
Loving Son, Brother
Husband, Father
- 102 Torrey
1911 James M. Torrey 1998
His wife
1910 Ura M. Smith 1983
- 103 Bernard McAvoy
1911 – 1962
Hazel Torrey
1919 -
- 104 MAGNIN FAMILY STONE
Joseph A. Magnin
1863 – 1894
- His Wife
Mary Magnin Swaurtout
1869 – 1921
- Wallace Magnin
1894 – 1895
- Maude Magnin
1894 – 1895

105	Same as 100		
106	Howard Blake Died Apr. 20, 1900 AE 23 yrs.		
107	Herbert N. Smith 1877 – 1959 Alice M. Smith 1880 – 1974		
108	Timothy L. Stanton Jr. 1/9/1964 – 11/13/2005 Epitaph: Loved by All		
109	Howard O. Blake Nov. 1, 1924 – Jan. 13.2001 Marie H. Provost Aug. 3, 1927 – Jan. 2, 2009	Howard O. Blake Sr. PFC US ARMY World War II Nov 1 1924 Jan 13 2001	VETERAN
110	FATHER Wesley A. Pierce		
111	William R. Pierce July 27, 1852 Feb. 25, 1917 His Wife Emma A. Burby Dec. 19, 1847 Dec. 10, 1908		
225	<u>STEARNS</u> Harwin A. Stearns Died Nov. 12, 1897 Age 41 yrs. 9 ms. 14 dys.	Missing stone, location uncertain between 111 and 112 as per the 1948 book. Burial recorded In section 4 of Dalton's Main St. Cemetery	

112 PIERCE FAMILY MONUMENT

East face

Father

Henry B. Pierce

Died Apr. 17, 1885

Aged 75 yrs. 6 m. 28 d.

Plus a personal stone H.B. Pierce (116)

Mother

Lydia D. Pierce

Died Apr. 2, 1885

Ae 72 yrs. 6m. 15 d.

Plus a personal stone L.D. Pierce (115)

North face: No Inscription

West face

James M. Pierce

Died Oct 5, 1852

Aged 20 Yrs

Plus a personal stone JMP (117 / 119)

Sarah E. Pierce

Died Jan. 10, 1880

Aged 47 yrs

Not in 1948 book

South face

Wesley A. Pierce

Died Nov. 24, 1895

Aged 59 yrs. 8 m. 13 d.

Sarah E.

His Wife

Died Dec. 3, 1904

Aged 61 yrs. 1 mo. 8 d.

113 FLOSSIE

Florence B.

Dau. of

W.R. & E.A. Pierce

Died Sep. 30, 1881

Age 11 mos.

114 Edith A.

July 10, 1870

June 7, 1895

- Mabel H.
Feb. 23, 1874
July 7, 1897
Daughters of J.B. & E.A. Bartlett
- 115 Personal marker that reads L. D. Pierce
- 116 Personal marker that reads H. B. Pierce
- 117 James M. Peirce
Died
Oct. 6, 1852
AE 20 y'rs. 8 mo.
- 118 Archie L. Tower
1885
Buried in W Cummington
His Wife
Floyce Pierce
1882 – 1944
- 119 JMP Footstone for James M. Peirce (117)
- 120 Bertha L.
Wife of
Wilber Pierce
Died Dec. 11, 1908
Ae 25 yrs. 7 mos.
19 ds.
- 121 Paul A. Halvorsen 1964 - 1984 Paul A. Halvorsen **VETERAN**
PVT US ARMY (Bronze Marker)
Mar 27 1964 Sept 21 1984
- 226 In Memory of Richard Arnold Halvorsen **VETERAN**
SSG US Army
Oct 19 1936 Aug 16 2021
Loving Husband Father
Grandpa and Great Grandpa

122 BROWN FAMILY MONUMENT

<p>Murray E. Brown 1843 — 1910 Lucy B. Taylor His Wife 1838 – 1918</p>	<p>On-line resources indicate two additional names on this stone Henry P. Brown 1857-1950 Marjorie McMaster, his wife, 1868-1946 Names, however, are not obvious.</p>
--	---

123 TAYLOR

Mother
Celia Taylor
His Wife
Born Oct. 23, 1812
Died Jan. 12, 1886

Father
Roswell B. Taylor
Born
June 2, 1810
Died - Jan. 12, 1891

124 Footstone for 123

125 Footstone for 123

126 L.B.B. Footstone for 122

127 M.E.B. - Footstone for 122

128 Linda A. Bresinger
Dec 7, 1954 – Aug 12, 2005
Missing You

129 / 130

Dick and Marie Street

Richard A. Street
FA US NAVY
Korea
Apr 29 1930 Nov 26 2003

Veteran

'Marie' is likely not buried in North Cemetery with her second husband, Dick Street. Veronica Marie Hamilton is buried in Fairview Cemetery in Dalton MA. Her headstone reads: V. Marie Street 1933 – 2011.

131 Blanche M.
Billings
Died August 7, 1909
Aged 54 yrs. 3 mos.

- 132 Billings
James M. Billings Entry Not included in 1948 book
1831 - 1900
Harriet L. Billings Entry Not included in 1948 book
1834 – 1878

Emily I. Billings
1871 – 1895
- 133 Edwin Shumway VETERAN
May 17 1843
July 2 1926
- 134 Lottie P.
Wife of
Edwin Shumway
April 6, 1840
Feb. 28, 1899
Epitaph: At rest
- 135 EDWARDS FAMILY MONUMENT
West face Wm. A. Edwards
Died
Dec. 14, 1893
Age 77 yrs.

C. Maria,
His Wife
Died
Feb. 12, 1882
Age 65 years
- North face Ellen J. Edwards
Died
Apr. 21, 1871
Age 22 yrs.
4 months

- 136 Lizzy B. Torrey
Died
Feb. 23, 1885
Age 9 Mo's.
- 137 / 144 Robert W. Torrey
1913 – 1993
His wife
Ruth L. Furnald
1915 – 2001
- Robert W. Torrey **VETERAN**
CPL US ARMY AIR CORPS
World War II
May 14 1913 Jul 14 1993
- 138 Matie I. Hathaway
Bishop
Wife of
Thomas E. Torrey
Died Jan. 18, 1964
AE 71 years
- 139 Thomas E. Torrey
Died
Jan. 5, 1921
Ae 45 yrs.
7 mos. 20 ds.
- 140 Thomas J. Torrey
Co. F
45 Ill. Inf. **VETERAN**
- 218 Amelia M. Blowers
Wife of
Thomas J. Torrey
1850 – 1911
- 141 Betsey A.
Dau. of
Thomas J. &
Amelia M. Torrey
Died
Feb. 6, 1883
AE.11 yrs. 6 mos.

- 142 CLARA M. GARDNER
DIED
June 18, 1888
Aged 79.
- 143 No headstone or sign of burial
- 144 Veteran marker for 137
- 145 Unknown
- 146 Unknown
- 147 Homer J.,
Son of
W'm & Mary A.
Ball
died
Feb. 12, 1875
ae 10 m's.
- 223 Frank E.,
Son of Castanas & Fanny E. Brown
Died Aug. 17, 1855
ae 7 w'ks 2 da's
- Included in 1948 book
Headstone missing
Look for stone near Homer J.
Ball (147)
- 148 Freddie G. ,
Son of W'm & Mary A.
Ball
died
May 23, 1866
ae 3 y'rs.
- 149 Hattie M.,
Dau. of
W'm & Mary A.
Ball
died
Sept. 25, 1877
ae 1 m' o.

- 150 Sally Ball – Smith
Born Oct. 9, 1795
Died Aug. 29, 1879
Possibly known as Sally S.
Possibly married Josiah Smith
- 151 William Ball
Sept. 30, 1826
Nov. 24, 1905
- 152 Mary A.P. Ball
Apr. 8, 1838
July 9, 1928
- 153 Frank W. Ball
1871 – 1930
- 154 Walter W. Ball
Oct. 28, 1859
Feb. 27, 1940
- 155 Angie S. Ball
March 26, 1866
Feb 8, 1952
- 156 BALL FAMILY MONUMENT
- 157 In Memory of
Orlen
Son of
Col. Levi &
Dolly Peirce
who died
April 8, 1831
aged 25 years.
- 158 In
Memory of
Lydia M.
wife of Emory Peirce
who died
March 22, 1832
aged 21 years.

Her beauty here
In Death is lost

- 165 LOREY HOLCOMB,
DIED
March 20, 1858
Aged 68 years
LEORA,
Wife of
LOREY HOLCOMB
Died June 30, 1831
Aged 35 years.
- 166 Leora,
Wife of
Lorey Holcomb
Died June 30, 1831
Aged 35 years
- 224 BEALS
Harvey F., son of Wheelock & Olive Beals Included in 1948 book
Died Aug. 9, 1825 Headstone missing
Aged 2 years & 7 months
- 167 No headstone present
- 168 In
Memory of
Joel Jackson
who died
April 23, 1827
Aged 43.
- 169 In
Memory of
Betsey
Wife of
Joel Jackson
who died Feb. 10, 1842
AE 60

- 170 Adelfert P.
 Son of Marshal & Electa
 Jackson
 Died May 4, 1862
 Aged 21 y' rs 6 mo.
 Epitaph: Will be it so why should we weep
 When thou art free from pain
 And early laid thee down to sleep
 From sin and earthly stain
- 171 FAREWELL
 Electa
 Wife of
 Marshal Jackson
 Died
 July 4, 1864
 Aged 47
- 172 Marshall Jackson
 Died
 Feb. 28, 1870
 AE 62.
- 173 Eunice W.,
 daughter of
 Henry & Minerva
 Peirce, Esq.
 Died
 Feb. 29, 1824
 In the 4th year of her age
 Remainder below grade
- 174 A. Sidney Peirce
 Died
 Nov. 12, 1841
 AET 24 yrs.
 (stone by --- Sheffield, Mass.)
- 175 Charles W
 son of
 Henry & Eunice Peirce, Esq.
 died Jan. 16th 1815

in the 10 year of his
age

Charles W. son of
Henry & Minerva Peirce, Esq.
died April 17th 1816
Aged 8 months & 20 days.

- 176 In Memory
of
EUNICE,
Consort of
Henry Peirce, Esq.
who died Dec. 21st
1812 in the 32nd
year of her age
- 177 Mrs. MINERVA,
wife of
Henry Peirce, Esq.
died April 8, 1826
Aet 36 years
- 178 In
Memory of
Mrs. BARSHABE wife of
Mr. Levi Pierce
Who died Aug. 31, 1830
Aet. 87.
- 179 Mr. LEVI PIERCE
Died
Jan 1, 1826
Aet 87
- 180 ABILGAIL,
wife of
James Hathaway
Died
Oct. 21, 1821
aged 80 y's.

VETERAN
Entry Not included in 1948 book

- 181 JAMES HATHAWAY
 DIED
 April 29, 1817
 Aged 80 yrs.
- 182 LAVANCIA MARIETTE PIERCE
 Feb. 2, 1820
 May 25, 1907
- 183 EDWARDS FAMILY MONUMENT
 South face Albert L. Edwards (no dates)
- Susan B.
 His Wife
 Died
 Aug. 29, 1855
 Age 36 Y'rs.
- West face Sarah M. Edwards
 Died
 Oct. 31, 1869
 Age 25 years
- North face Sarah E
 Died
 Mar. 28, 1842
- Susan
 Died
 Sept. 7, 1855
 Children of A.L. & Susan B. Edwards
- 184 Susanna
 Wife of Shadrach
 Hathaway
 died May 8, 1816 in
 the 45 year of her age
 Epitaph: The sweet remembrance of the just
 Shall flourish when they sleep in dust

- 185 Shadrach Hathaway
Died
Feb. 15, 1845
Aged 72 yr's & 4 m'o.
- 186 Stilman Axtell
died July 16th
1813 in the 12
year of his age
- 187 Mr. William Axtell
died October 5th 1813
in the 47th year
of his age
- 188 Footstone for 187
- 189 In VETERAN
Memory of
Lieut. Thomas Axtell
Who died
Feb. 26th 1818
in the 64th year of his age.
- 190 Mrs. Rebecca,
wife of Mr. Thomas Axtell
who died July 26th
1813 in the 55th
year of her age.
- 191
- | | | |
|--|---|--|
| | Abigail
Daughter
Of Thomas
& Rebecca
Axtell died
May 15th
1803 Aged
11 years | Silas
Son of
Thomas
& Rebecca
Axtell, died
October 11th
1810, Aged
17 years |
|--|---|--|

- 192
- | | |
|--|--|
| Samantha
Daughter of
Ebnr & Eleanor
Axtell, died
March 2 nd 1811
in the 2 nd year
of her age | Vollaire
Son of
Ebnr & Eleanor
Axtell died
July 27th 1810
Aged 4 days |
|--|--|
- 193
- To our Father
Ebenezer Axtell
Died
May 11, 1849
Aged
66 y'rs. 3 mo. &
19 d's.
- 194
- Mrs. Elener
wife of
Mr. Ebenezer Axtell
died Dec. 13, 1830
AEt 42
Epitaph: No age nor sex can death defy
Think mortals what it is to die
- 195
- Unreadable
- 196
- Mrs. Esther
wife of
Mr. John Hathaway
died Oct. 6, 1798
aet 23 years.
- 197
- | | |
|---|---------------------------|
| Mrs. Lucy
wife of
Mr. Christopher
Miner. died
March 6, 1825
AE t 81 yrs. | Not included in 1948 book |
|---|---------------------------|

- 198 Mr. Christopher Miner Died Sept. 24, 1815 AEt 72 yrs. 'N' in Miner on headstone is reversed
- 199 Footstone for 200
- 200 Nathan Miner Died July 4, 1854 aged 84 yrs.
- 201 Mrs. Dolly Wife of Mr. Nathan Miner, died Octr. 19, 1817 Aet 46 yrs.
- 202 Affa Miner Died Jan. 24, 1850 Aged 65 yrs.
- 203 Mrs. Deborah Wife of Mr. William Miner died Jan. 25, 1815 AEt 21 years.
- 204 David Worthington Died April 20, 1818 Age 63 **VETERAN**
205 - original stone covers grave
- Affa Gilbert His Wife Died April 18, 1834 Age 77 yrs.

1961

- 206 No Entry
- 207 Thomas P. Keefe
March 17, 1949
Dec. 10, 2005
- 208 Charles H. Ball
1861 – 1928
- 209 Cora E. Ball
1866 – 1911

BROWN FAMILY MONUMENT

Personal stones

- 210 Mother
Salome
wife of Orren Brown
Died
Sept. 22, 1866
Aged 59
- 211 Janie
Died
Sept. 20, 1866
Aged 15 yrs.
- 212 Effie J.
Died
Sept. 24, 1866
Aged 20 yrs.
- 213 Jamie G. Two headstones with same date exists for James G.
Died April 16, 1832
aged 2 yrs.
- 213 James G.
Son of
Orrin & Salome
Brown
died
April 16, 1832

Aged 2 years

222 MINER (stone broke in half on ground) Included in 1948 book
Henry, Son of Demmon & Lucy Miner Headstone missing
Died Sept. – 1850 burial likely between
Brown Family Mon (212) and
Torrey Fam Mon (214)

214 TORREY FAMILY MONUMENT

East face

Betsey L.

Died

July 4, 1870

AE 34 yrs.

Sarah A.

Died

Jan. 13, 1871

AE 30 yrs.

Daus. of

Ezra & Armeda

Torrey

West Face

Ezra Torrey

“Father’ Personal Marker also exists

Died

June 22, 1890

AE 82 yrs.

215 BROWN FAMILY MONUMENT

216 Martindale
Willard Wesley
1-20-1931 – 6-11-2016
Wife
Cora E. Rowe
3-13-1927 – 12-28-2008

VETERAN

219 Unknown footstone with ‘G.L.R.’

220 Unknown footstone with ‘S.A.F’

221

Beloved husband, son
Brother, father
Todd Michael Stanton
6-3-1965 – 6-14-2009

SOUTH (WHEELER or MIDDLEFIELD ROAD) CEMETERY

FROM 1948 BOOK: This cemetery is located beside the road from Peru to Middlefield, in the south part of the town. It is near the town line between Hinsdale and Peru. It is sometimes called the Wheeler Cemetery or the Middlefield Road Cemetery. It is in a good state of repair, and burials are still made there. It is copied from front to back by row, starting with the left-hand corner in the front.

This cemetery is located on what is now Middlefield Road and is included in the Massachusetts Cultural Resource Information System (MACRIS) database. The cemetery map shows individual graves rather than sections in the cemetery. The approximate location of the cemetery is 42.42152 - 73.07714. The elevation of this cemetery is 1592ft. / 485m.

Because interments were not done a specific grid, locations of headstones and graves are approximate.

Row	Section 1		Section 2	Section 3	4	5	6	7	8	9		10	11	Row
21														21
20														20
19		X	X	X	X	X	X	X	X	X				19
18		X	X	X	X	X	X	X	X	X				18
17		X									X			17
16		X									X			16
15		X									X			15
14		X									X			14
13		X									X			13
12		X									X			12
11		X									X			11
10		X									X			10
9		X									X			9
8		X									X			8
7		X									X			7
6		X									X			6
5		X									X			5
4		X									X			4
3		X									X			3
2		X									X			2
1		X									X			1
Row	Section 1	East Gate	Section 2	Section 3	4	5	6	7	8	9	West Gate	10	11	Row
					X	Designates drive access to cemetery								
← Middlefield Road →														

Row 1 – This row is located to the east of the East Gate

1-1 Not Available

1-2

1-2 Janice P. Richardson
Died June 8, 1972, aged 46 years

Unmarked grave

1-3 and 1-4 Open

1-5 BROOKS

BROOKS

Lyndon R.
Mar 18 1919
Mar 31 1998

Grace B.
June 17, 1921 –
(Date of death, March 4, 2017,
not inscribed)

Lyndon R. Brooks
PFC US ARMY
World War II
Mar 18 1919 – Mar 31 1998

VETERAN

1-6 STEELE

STEELE

Laurin R. (VETERAN)
1949 -

Murielle L.
1952 - 2013

Married 1970
John 3:7
1978 Born Again 1968

1-7 PELKEY

PELKEY

Alicia D.
1919 – 1994

Nelson D. Sr.
1909 – 1985

1-8 to 1-10 Open

1-11 LAMBSON / HEATH

Roland H. Lambson
1900 – 1975
Gertrude A. Heath
1899 His Wife 1980

1-12 Open

1-13 Charlene F Steele
5/11/1954 -
Blessed daughter, sister, & aunt
Praise the Lord! I saw the light
Elementary School teacher for 34 years
John 3:16

1-14

STEELE

Robert R.
1926 – 2003

Eleanor M.
1922 – 2018

Robert R. Steele
PVT US ARMY
World War II
Nov 17 1926 Aug 10 2003

VETERAN

1-15 BUNT

Bunt

Marjorie A.
1902 – 1980

Clayton F.
1885 – 1969

1-16 Jean Alice Frusciente
b. 8/7/1950 Pittsfield
d. 5/5/1971 Washington

Unmarked burial to left of father,
Martin Frusciente

Edwin 'Ted' Pilson Frusciente
b. 9/17/1948 Pittsfield.
d. 9/10/1995 Pittsfield

Unmarked burial to left of sister,
Jean Frusciente

Frusciente Baby, Died Feb. 1, 1965.

Unmarked burial

1-17 Martin Frusciente
PFC US ARMY
World War II
1916 – 1977

VETERAN

Alice Frusciente
September 29, 1925 - July 1, 2021

Cremated remains interred
September 2021 atop husband

Martin Frusciente
Grave marker not installed

Samuel 'Sammy' Frusciente
b.9/11/1951
d. 8/3/2021

Unmarked burial. Cremated
remains interred atop father,
Martin Frusciente

1-18 DuCHARME

Mother

Father

DuCharme

Florence L.
1920 – 1964

Clifford F.
1912 – 1985

1-19 J. Traylor
1873 – 1943

1-20 STEELE / PELKEY

PELKEY

Book of Life

Coralie E.
Steele
June 11, 1948

Nelson D. Jr.
"Sonny"
Sept. 28, 1938
Dec. 19, 1993

In my father's house there are many mansions John 14:2

1-21 Laura C. Pelkey
1942 – 1974

Row 2

- 2-1 to 2-3 Open
- 2-4 Unmarked Footstone
- 2-5 to 2-9 Open
- 2-10 Unmarked Footstone
- 2-11 Reserved
- 2-12 Reserved
- 2-13 WEILAND-BOLIO
Nathan Auguste
"Nate"
8-6-83 9-16-03
Beloved son of

Diane E. Weiland & Craig R. Bolio

Eric Weiland Cremated remains interred on August 27, 2023
March 31, 1958 - August 4, 2023

2-14 to 2-17 Open

2-20 Reserved

2-21 In loving memory
 of
 Susan F
 Avery
 Oct. 5, 1954
 Apr. 7, 2006

Row 3

3-1 GEER
 Ira Milo Geer
 February 6, 1834 – June 9, 1858

3-2 and 3-3 Open

3-4 HASKELL FAMILY MONUMENT
Face Lester Haskell
 1805 – 1879

 Jane E. Dolby,
 His Wife
 1821 – 1862

Back

Children

Nathan W. – 1845 – 1911 **VETERAN**
149 Mass. Vol. Co. D — 2nd Mass. Cavalry

Noah D. - 1851 – 1923

Nelson W. — 1847 – 1924 **VETERAN**
Co. D. 2nd Mass. Vol. Cavalry

Carrie G., His Wife
1847 – 1927

3-5 Father

Lester Haskell
Died Nov. 20, 1879
Aged 74 y'rs. 9 mos.
Epitaph:

3-6 Mother

Jane E., Wife of Lester Haskell
Died Mar. 26, 1862

Headstone missing
Footstone in place

3-7 and 3-8 Open

3-9 GRISWOLD

Our loved ones
Willie L.
Died
April 29, 1868
Aged 14 days

Georgie W,
Died
July 11, 1870
Aged 1 year 3 month
sons of William &
Mayetta Griswold

3-1- to 3-15 Open

3-16 Alan Bongini

April 13, 1944 - March 8, 2023

VETERAN

Currently unmarked

3-17 WHELPLEY / MacKENZIE

In loving memory of
Virginia Viola MacKenzie
Feb. 24 1928 – May 29 2010
And her husband
Donald Howe Whelpley **VETERAN**
Jan 12, 1925 – July 20, 2017

WHELPLEY
Epitaph: "To live in hearts
We leave behind
Is not to die"

3-21 Frank J VETERAN
Kusiak
MM3
US NAVY
World War II
1924
2006

Row 4

4-1 Nelson S.
Son of John D. & Lovina Cole
Died Aug. 10, 1867 - Age 20 yrs.
Epitaph: (Not legible and now below ground)

4-2 Clara M.
Daughter of John D. & Lovina Cole
Died April 14, 1859
Aged 8 years.
Epitaph: Oh dearest and take thy rest
God called and Clara answered

4-3 John D. Cole
Died May 18, 1856
Aged 41 years

4-4 Open

4-5 Lovina Cole Ayres
1816 – 1900

4-6 D. M. Squires VETERAN
Co. B. (Born: 1840 Washington MA
37 Mass Inf. Died: July 21, 1906 Peru MA)

4-7 Open

POWELL
4-8 Charlotte
Wife of
Dorance Powell
Oct. 14, 1822

Dec. 11, 1900

Epitaph: My mother has gone to her rest

She loved all but loved her Saviour the best

She was always thoughtful and earnest
of this life and life eternal

Father

4-9 Dorance Powell

Aug. 6, 1826 - July 1, 1906

Epitaph: His motto through life was the Golden Rule

4-10 Open

4-11 Edward Von Glahn

June 18, 1842

Jan. 21, 1916

3-12 to 4-17 Open

4-21 FRUSCIENTE / KLEIN

Martin Frusciente, Jr.

Oct. 8, 1947 – Mar. 2, 2018

Wife

Virginia A. Klein

Aug. 31, 1947 – Apr. 28, 2003

Row 5

5-1 Open

5-2 Unknown Footstone

5-3 Riley A. Cole

Died Feb. 1, 1844 ae 21.

Epitaph: Remember thy creator in the days of thy youth

5-4 WELLS

1920 Maynard G. 1986

1922 Alice M. 2005

Maynard G Wells

PVT US ARMY

World War II

1920 1986

VETERAN

5-5 Spencer Cole
Died
Aug. 10, 1850
Aged 54 years

5-6 to 5-13 Open

5-14 Reserved

5-15 Reserved

5-16 and 5-17 RICHARDS

RICHARDS
Edward Palmer
September 26, 1934
November 29, 2022
(Date of death not added)
VETERAN

In memory of
our beloved son
Eric 'Steven' Richards
Oct. 4, 1964
Nov. 22, 2013

Sarah Christine
Dec. 6, 1936
January 18, 2023
(Date of death not added)

5-20 and 5-21 WHITCOMB

Neal E.
Feb. 21, 1988 –

Kathleen A.
Oct. 6, 1942 – Mar. 26, 2018

Row 6

6-1 Lydia
Wife of Nathan Standish
& daughter of Ezra Cole
Died
Jan. 13, 1830
AE 44.

6-2 In Memory of Susan
Wife of Ezra Cole
Who died Jan. 4, 1829 AEt 70.

First burial in South Cemetery

- 6-3 Ezra Cole
 Died Sept. 28, 1843 Aged 86
 Epitaph: Suppress your grief, dry up your tears
 his dust must rest till Christ appears
 My friends be still, and eye the rod
 And know the hand that struck was God.
- 6-4 On-Line resources provide the following:
 Ezra Cole Jr.
 Born April 18, 1791 in Peru (Find-A Grave)
 Died May 10, 1814, buried in South Cemetery (Find-A Grave,
 PeopleLegacy and Peru Vital Records)
 No headstone is in place for 6-4 but an opening exists between the
 headstones of Ezra Cole Sr. (6-3) and Doly Cole (6-5) and the lower half of
 a headstone without inscription is behind Ezra Cole Sr's headstone. 6-4
 could be the burial location for Ezra Cole Jr. but it is not substantiated.
- 6-5 Doly Cole
 Died Dec. 31, 1858
 Aged 71 years & 6 m's. Stone marked 'G.F.'
- 6-6 Unmarked Stone
- 6-7 and 6-8 Open
- 6-9 ANDRUS
 Harley E. – 1876 – 1942
 His Wife
 Carrie L. – 1861 – 1917
- 6-10 and 6-11 Open
- 6-12 Reserved
- 6-13 CORBETT / EVANGELISTA
 William J. Jr.
 1939 - 1994

 Anna M. Evangelista
 1941 -

6-14 Reserved

6-15 CORNELLIER

Paul F.

Jan. 9, 1944 – Feb. 11, 2007

Janet F. Swope Battaini

Dec 21, 1933 -

6-16 and 6-17 – Richards

6-20 and 6-21 – Whitcomb

Row 7

7-1 DROSEHN / SANDERSON

1927 Edwin C. Drosehn, Sr. 1991

His Wife

1922 Kathleen E. Sanderson

(2013 date of death not inscribed)

VETERAN

Their sons

1948 Edwin C. Drosehn, Jr

1950 – Donald J. Drosehn

7-2 DROSEHN / LANDAU

1877 Fred F. Drosehn 1959

His Wife

1885 Nettie C. Landau 1972

Son

1915 James H. Drosehn 1962

Son

1912 Frank W. Drosehn 1973

7-3 SEVERY

Nancy A.

Died

Feb. 28, 1833

Aged 2 years

Daughters of Reuben S. & Nancy Severy

Betsey J.

Died Feb. 22, 1833

Aged 4 years

- LYMAN
- 7-4 Sarah A.
Daughter of
Isaac & Sarah A.
Lyman
died Mar. 26, 1860
AE 28 years & 11 mo.
- 7-5 Nancy M.
Daughter of
Isaac & Sarah A.
Lyman
Died Jan. 19, 1853
Aged 19 years
& 9 m's.
- 7-6 An Infant of
Isaac & Sarah
Lyman
Died
Sept. 18, 1837
Aged 6 weeks.
- 7-7 Open
- 7-8 Martha
dau. of
Isaac & Sarah
Lyman
died Febr. 12th
1844. AE 5 mo.
- 7-9 Sarah A.
Wife of
Isaac Lyman
Died
July 25, 1844
AE. 33 yr.
- 7-10 Isaac Lyman
Died
Sept. 1, 1876

Aged 76 years
& 5 m's.

7-11 Vendla Berggren
1875 – 1954

7-12 John H. Berggren
1879 – 1964

7-13 Carlos W. Wiggin
1862 – 1937

7-14 Open

7-15 DROSEHN / MILLER
Edward L.
Oct. 26, 1946

Jean E. Miller
Feb 25, 1946 – Dec. 13, 2017
Epitaph: The seed was sown
The harvest over

7-16 and 7-17 Open

7-20 RUSSELL
Cody Joseph Russell
Oct. 27, 2001
Epitaph: Beloved son and brother
Let the little children come to me
And do not hinder them for the
Kingdom of God belongs to such as these

7-21 RUSSELL
Jennifer E.
Apr. 17, 1966 – Sept. 23, 1989
Epitaph: Always in our thoughts
Forever in our hearts

Frank Russell
1961 – 2020

VETERAN

Epitaph: Forever Loved.

- 8-9 Ronald S. Wheeler **VETERAN**
Massachusetts
PFC CO C 5 Cavalry
Korea
Aug 8 1928 Nov 10 1957
- 8-10 Open
- 8-11 WHEELER / FERRY **VETERAN**
Cortney Squires
Jan. 16, 1935 – July 2, 2014
- His Wife of 60 Years
Elizabeth A. Ferry
June 17, 1935 –
- 8-12 WHEELER
1898 Charles S. Wheeler 1960 Charles S. Wheeler **VETERAN**
His Wife Massachusetts
1908 Ina Culver 1998 PVT Co F 104 Infantry
World War I
June 28 1898 Aug. 12 1960
Ina M Wheeler
Jan 26 1908 July 8 1998
- 8-13 and 8-14 Open
- 8-15 VREELAND
Donald
1912 – 1964
- Madalene
1912 – 2000
- 8-16- and 8-17 Open
- 8-20 and 8-21 Russell

Row 9

- 9-1 Clarissa G. Wheeler
Wife of
Nathan W. Wheeler
Died
Jan. 5, 1888
age 76 y'rs.
- 9-2 Nathan W. Wheeler
Died
May 31, 1859
aged 48 y'rs.
Epitaph: Not dead but sleepeth
- 9-3 Cornelia Ann
Wife of
Lyman A. Geer
Died
August 12, 1844
AE 28
Epitaph: How Sweet she shone in social life
As daughter sister friend and wife
Her race was swift her rest is sweet
her joy sublime her bliss complete
- 9-4 Lyman A. Geer
Died
March 13th, 1846
AE 27.
Epitaph: Thy virtues and thy worth
Shall fond remembrance cheer
And ease the aching heart
That drops the falling tears
- 9-5 In
Memory of
Alpheus Geer
Who died
April 12, 1846
AE 63
Epitaph: His body rests beneath the sod

His spirit winged its way to God
But when our mortal life shall cease
We hope to meet his soul in peace

E.M. Shepardson
N. Lenox

- 9-6 In
Memory of
Keziah Judd,
Wife of
Alpheus Geer.
Who died
Oct. 3 1846.
AE. 64.
Epitaph: She
needs no marble monument
to tell her worth.
- 9-7 Willis A. Wheeler, son of
Arthur S. & Alice M. Wheeler
Died Dec. 25, 1889—Age 1 yr. 8 mos. Entry included in the 1948 book
Headstone missing
Location is an estimate.
- 9-8 Open
- 9-9 WHEELER
Front: Arthur S. Wheeler
1852 – 1898

Alice M. Squires
His Wife
1856 – 1922

Back: William A. Wheeler Same dates as the 9.7 entry.
1888 – 1889

Edwin I. Wheeler
1896 – 1942

Personal stones: Edwin - Mother — Father — William
- 9-10 and 9-11 Open

9-12 DRAKE / REYNOLDS
Leon I.
Oct. 23, 1913 – Feb 16, 2002
Wife
Ruth M. Reynolds
May 9, 1918 – June 27, 2001

REYNOLDS

9-13 George W. Reynolds
1888 - 1961
His Wife
Clara Wheeler
1886 – 1960

9-14 Open

9-15 SHUTTLEWORTH
Merlynn R.
Shuttleworth
Sept. 12 1941
Apr. 13, 1985

William O.
Shuttleworth
June 21, 1939
May 25, 1999
VETERAN

VETERAN

9-16 Open

GREEN

9-17 Charles W. Green
1901 – 1969

Mother
Bertha Wheeler Green
1884 – 1933

Children
Arthur Green
1908 – 1909

Martha Green
1906 – 1914

9-18 Pearl A. Green
Wife of
Ernest Wilson
1905 – 1985

9-20 and 9-21 CULLETT – LAMBERT
William A. Cullett
1914 – 1985

Leona Berry Cullett
1917 – 1998

Her Mother
Helen Colby Berry Lambert
1897 – 1983

Row 10 – This row is located west of the west gate

10-1 Not Available

10-2 Our baby Marion
Daughter of
Ernest & Helen Orpin
Jan, 28, 1921
Feb 21, 1921

10-3 Open

10-4 Bruce Melvin Cornwell
SA US NAVY
Jan 29 1931 – June 25 2013

VETERAN

10-5 through 10-9 Open

10-10 WOOD

Sarah E.
Died Mar. 23, 1909
age 12 years.

Arthur L.
Died Aug. 17, 1900
age 18 days

Children of Anthony & May Wood

10-11 and 10-19 Open

10-20 and 10-21 LaROCHELLE

10-21 Stephen P. LaRochelle
March 30, 1998 - August 12, 2023

Row 11 – End row, against fence. A few headstones face away from the cemetery

11-1 Florence L. Kilbourn
Wife of Lewis Franklin
Died
Nov. 11, 1909
Age 24 years

11-2 Mary A.,
Wife of W. H. Kilbourn
Died
June 27, 1895
aged 49 yrs.

11-3 Nellie C.,
Wife of
W.H. Kilbourn
Died Jan. 5, 1906
AE. 57.

11-4 Robert W. Cornwell
1898 – 1979
His wife
B. Evelyn Wesley
1898 – 1968

11-5 Madeline E.
Cornwell
1905 – 1983

- 11-6 Brewster L. Cornwell
Aug. 20, 1896 – July 4, 1945
- 11-7 CORNWELL
1856 – Charles H. – 1946
His Wife
1865 – Ellen M. – 1924
- 11-8 Open
- 11-9 Father
Lot W. Brewster
Died
Aug. 17, 1896
Age 69 yrs.
- 11-10 Mother
Martha L.
Wife of
Lot W. Brewster
Died June 8, 1892
Age 65 yrs.
Epitaph: Asleep in Jesus' blessed sleep
- 11-11 to 11-14 Open
- 11-15 James S. Barnes
Died
May 26. 1915
Aged 85 yrs.
- 11-16 Lucena V. Geer
Wife of
J. S. Barnes
Died
Nov. 5, 1909
Aged 70 years
- 11-17 Open

WETZEL

11-18 Ina K. Wetzel
1883 – 1987

11-19 Fanny B. Glendenning
Wife of
William F. Wetzel
1865 - 1956

11-20 William F. Wetzel
1857 – 1919

11-21 Orpha D. Glendenning
1855 1917

Entry not included in 1948 book

FORD FAMILY CEMETERY

In 1948, this cemetery was described as: Years ago, A PRIVATE CEMETERY, located near the main road leading from Hinsdale to Peru Hill and near the old residences of Elisha Rockwell and Roderick Ford. Today, this cemetery of two graves would be described as being off of the north side of Rt. 143 and across from Camp Danbee.

In
Memory of
Lora V.
daughter of
Charles & Anna
Ford, who died
Aug. 18, 1831
aged 26 years

In
Memory of
Harris
son of
Charles & Anna
Ford, who died
June 30, 1831
aged 33 years

Both graves are accompanied by foot stones marked with their initials, LVF and HF, respectively.

The approximate location of the cemetery, on private property, is 42.447067 - 73.073817. The elevation of this cemetery is 1654ft / 504m

SOUTH THOMPSON BURIAL GROUND

1948 Book: This Burial Ground is located on private property on Route 143, 0.9 mile east of intersection of Route 143 with South and North Roads, on the south side of the road.

2023: An early document suggests that this burial ground is located on Rt. 143 near the intersection of North and South Roads and that the first burial occurred in 1827. While this Burial Ground is not included in the 1948 Tombstone Inscription book, it is included in the 1981 entry in the Massachusetts Cultural Resource Information System (MACRIS). The South Thompson Burial Ground is located, adjacent to the old S. Thompson home location and 130 yards west of Curtin Rd. along the south side of Rt. 143 and 25 – 30 feet in from the road. The Burial Ground consisted of 6 granite posts arranged in a 20' x 40' rectangle. At the time of the MACRIS entry, access was denied by the then owner as this is private property. At that time, two headstones were observed to be leaning against a tree directly behind the rectangle of posts. These were likely the top and bottom halves of Joseph Thompson's headstone which have been cleaned. Today, the Burial Ground is marked by 5 granite posts (the sixth is missing).

More recently in 2020, the current owner of the property has permitted access. Five of the six original granite posts remain and the two halves of Joseph Thompson's (b. 1789, d. 1827) headstone has been found, cleaned and return to the locale. No other headstones have been located. Records indicate that graves for Joseph Thompson and his son, Clark Payne Thompson, are located here. There is a possibility that one additional grave exists.

Joseph Thompson's headstone reads:

In memory of
Joseph Thompson
who died December 19, 1827
in the 38th year of his life.

Joseph Thompson was born June 4, 1790 in Peru and died December 19, 1827 in Peru

The Guide to Berkshire County Massachusetts Cemeteries includes a section on small burial grounds, which reads:

In memory of Clark Payn
son of Joseph & Hannah Thompson
who died February 7, 1838

Clark Payne Thompson was born February 5 or 6, 1818 in Peru and died Feb. 7, 1838 in Peru

The approximate location of the burial ground is 42.434207 - 73.02849. The elevation of this cemetery is 1941ft / 592m.

DOROTHY FRANCIS RICE WILDLIFE SANCTUARY

A single headstone can be found along one of the hiking trails, that of Stephen J. Phillips

Within the 300-acre Dorothy Frances Rice Sanctuary on South Road beyond the former caretaker's cottage and on the Red Trail, is a memorial to honor the late Stephen J. Phillips, a Peru resident (1947-1995), who had served with distinction in the U.S. Navy during the Vietnam War. A short path leads to a plaque flanked by small American flags.

SOUTH ROAD EXTENSION CEMETERY

Garnet Lake is man-made and located where the Ferguson family farm was settled in the 1860s. A memorial for Sarah Corinth Cross Ferguson is located along Causeway Road, approximately 300ft. east of the intersection with South Road Extension, on private property. It is thought that this location marks a favorite spot of Sarah's. Her and her husband Justin's names are included on stones in section 5 of the Maple Street Cemetery in Hinsdale MA. Only one monument can be seen and that is for Sarah.

Sarah C
Wife of
Justin Ferguson
Died Sept 18, 1852
Aged 27 yrs

The epitaph reads: Precious in the sight of
the Lord is the death of
his saints

The lower right corner of this monument contains two lines of text which are not currently readable.

There is speculation that other graves may be included in this small cemetery.

The cemetery is roughly 25 feet deep and 30 feet wide. The approximate location of the memorial is 42.40942 - 73.05135. The elevation of this cemetery is 1873ft / 571m

Garnet Mountain Crash Site

A document such as this would not be complete without an acknowledgement of the Garnet Mountain plane crash, which occurred on a foggy night during World War II involving a Douglas C-53-DO troop transport plane. The following was installed at the crash site atop Garnet Mountain on the south side of Peru.

THIS TABLET ERECTED
IN MEMORY OF
THE FOLLOWING WHO GAVE
THEIR LIVES HERE IN
A PLANE CRASH AUG. 15, 1942
WHILE IN THE SERVICE OF
THEIR COUNTRY

JOSEPH J. FIELDS
HYMAN B. FLINKMAN
SAM B. HATHORN
JOHN H. KELLEY
ROBERT W. LAMON
FRANK A. LASTOSKY
JOSEPH C. NEUROHR
JACK E. PALMER

GARDNER V. PLAIN
STANLEY E. RACINE
NORMAN SANDS
STEVE E. SCHOLLIN
CHARLES M. SCOTT
JAMES E. THOMPSON
AUSTIN W. WEECES
JAMES D. WESTBROOKS

The trail head / parking area is on Curtin Road and located at 42.393374 - 73.01535.
The elevation of this location is 1776 ft / 541m.

FAQs

In conversations about inscriptions, epitaphs and cemeteries, a few topics and questions are recurring. This short explanation of terms is provided to help orient the reader and answer a few of those questions

What is the difference between a cemetery, a graveyard and a burial ground?

The word cemetery implies that the land is specifically designated as a burial ground. It originally applied to the Roman catacombs. The term graveyard is often used interchangeably with cemetery, but a graveyard primarily refers to a burial ground within a churchyard.

What does 'consort' and 'relict' mean on the headstones of wives?

On older stones, the term consort or relict was used to describe the woman's marital status. Consort is used when the wife has died before the husband leaving him alone. Relict (Relick, Releek, Relect) is the same as a widow, hence dying after her husband, she being left alone.

What is the difference between a gravestone, a tombstone and a headstone?

Each is a grave marker.

The word "gravestone" is Middle English in origin and dates back to between the years 1175 and 1225. The word was used specifically to refer to a stone slab that was laid over a grave.

The word "tombstone" first came to the English language around the year 1560. In this era, many coffins were made out of stone. "Tombstone" initially was coined to describe the lid of a stone coffin.

By the second half of the 1700s, "headstone" had fully evolved to a new usage defined as "upright stone at the head of a grave." In some instances, headstones are paired with footstones which marked the other end of a grave. Footstones are no longer in favor.

You'll hear these terms being used interchangeably but there are subtle differences.

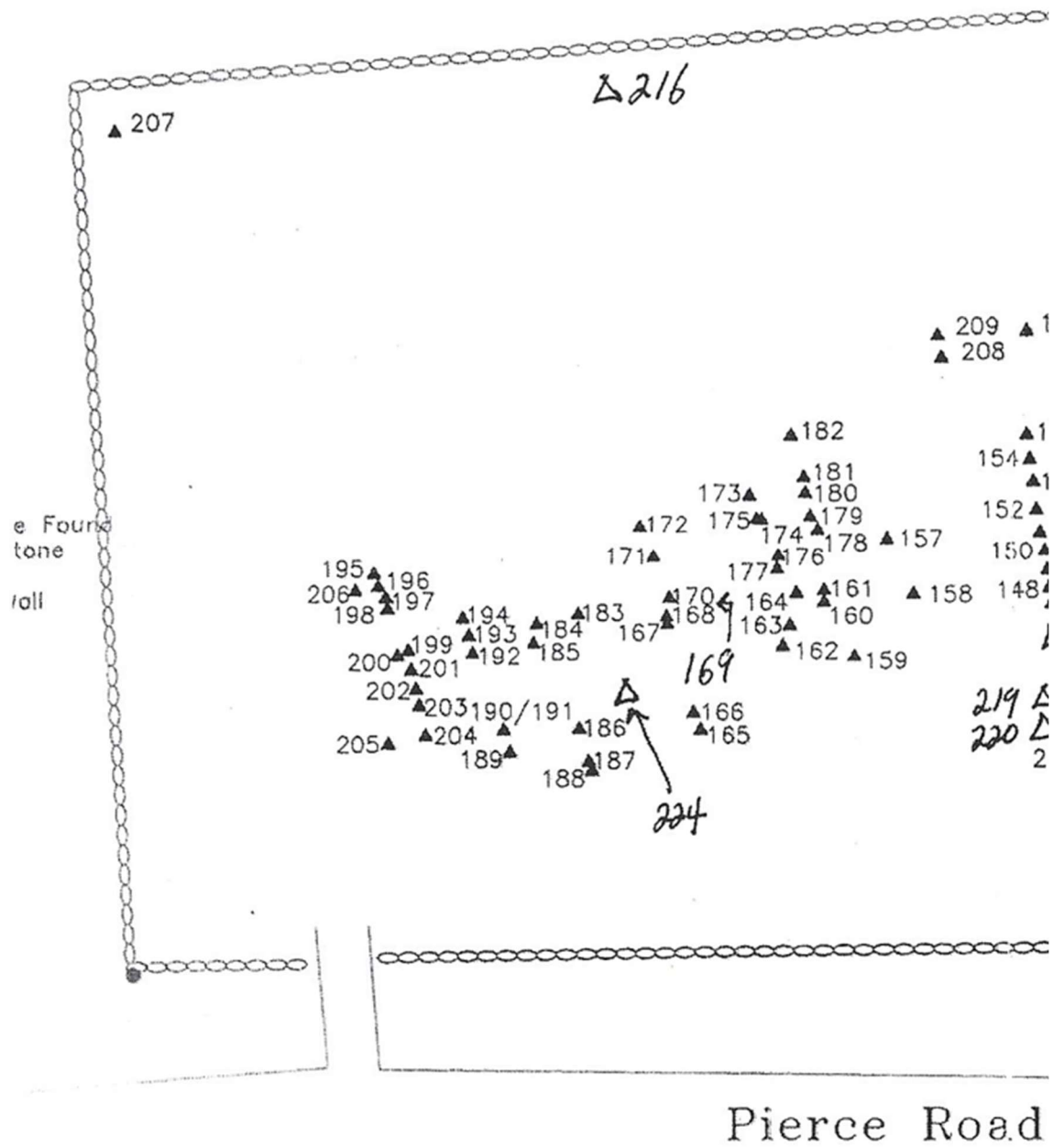

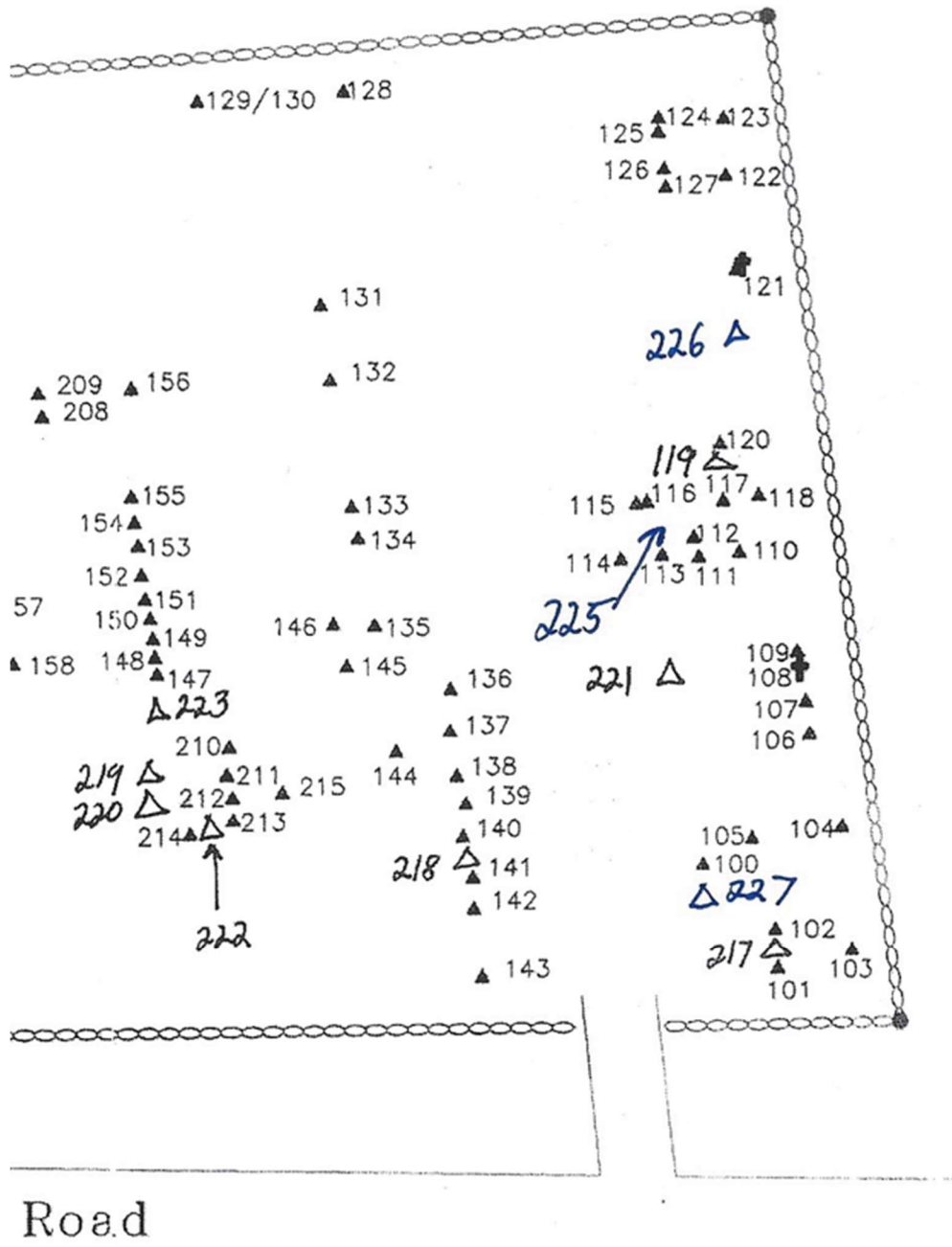

FULL CEMETERY INDEX

		Thomas (Lieut.)	189
		Thomas	190
		Vollaire	192
		William	187
ABBE			
	Anna	D10	
	John	C10	
	Rojer	C10	
ABBOT			
	Anna	B11	
	Amelia O.	B11	
ACKERT			
	Belker W.	C8	
	B.W.	D7	
	Ethel I.	D7	
	Ethel L.	C8	
	Lord M.	C8	
	Margaret	D7	
	Maria E.	C8	
ALLGAIER			
	Carretta H.	I10	
ANDRUS			
	Carrie L.	6-9	
	Harley E.	6-9	
ATWATER			
	Abigale	B12	
	Allen	B12	
	Leverett	B12	
AVERY			
	Susan	2-21	
AXTELL			
	Abigale	191	
	Ebenezer	193	
	Eleanor	192	
	Elener	194	
	Rebecca	190	
	Samantha	192	
	Silas	191	
	Stilman	186	
		AYRES	
		Lovina Cole	4-5
		BACON	
		Joseph	G9
		Joseph, Jr.	G9
		Lucy d1840	G9
		Lucy d1853	G9
		BALL	
		Angie S.	155
		Charles H.	208
		Cora E.	209
		Frank W.	153
		Ball Family Monument	156
		Freddie G.	148
		Hattie M.	149
		Homer J.	147
		Mary A.P.	152
		Sally Ball Smith	150
		Walter W.	154
		William	151
		BALLOU	
		Amariah	B12
		Amariah Jr.	B12
		Elias	B12
		E.M.	H11
		Eunice Murette	H11
		L.D.	H11
		Lucinda	B12
		Lyman D.	H11
		Mary d1842 (nee Parker)	B12
		Mary d1840 (nee Freeland)	B12
		Nellie M.	H11
		Russell	B12
		Willie D.	H11

BARKER			BENTON	
Lucy A.	B11		Hannah	E10
William C.	B11		Jacob	E10
BARLOW			BENNETT	
Myra Elizabeth	F6		Kimberly L	G8
BARNABEE			BERGGREN	
Chandler	D12		John H.	7-12
Delight	D11		Vendla	7-11
F.	D12			
Harriet N.	D11		BERRY	
J.	D12		Helen Colby Berry Lambert	9-20
J.A.	D12			
James	D11		BILLINGS	
O.	D12		Blanche M.	131
Three Infants	D12		Emily I.	132
			James M.	132
			Harriet L.	132
BARNES			BISHOP	
James S.	11-15		Matie Hathaway	138
J.S.	11-16			
Lucena V. Geer	11-16			
BARTLETT			BLACKMAN	
E.A.	114		Betsey	H10
Edith A.	114		Nathaniel	H10
J.B.	114			
Mabel H.	114		BLAKE	
			Howard	106
BATTAINI			Howard O.	109
Janet F. Swope Battaini	6-15			
BEALS			BLOWERS	
Arvildia A.	H10		Amelia M.	218
Harvey F.	224			
Judson	H10		BOLIO	
Mary	H10		Arnold R	I10
Olive	224			
Wheelock	224		BONGINI	
			Alan Bongini	3-16
BEERY			BOTTUM	
Katie Marie	I9		Alce	C12
			Austin	C12

Diantha	C12	Clara A.	I9
John M.	C12	Daniel	C9
Lucy Thompson d1875	C12	David R.C.	A12
Mary T.	C12	Effie J.	212
Silas B.	C12	Elijah	H9
Whitfield R. (WR)	C12	Fanny E.	223
		Frank E.	223
BOURE		George L.	H9
Alexandrin	H12	Harriet	H9
		Henry D.	H10
BOWEN		James G.	213
Betsey	G10	Janie	211
Betsey Perry	G11	Jamie G.	213
Christopher	G10	Jane	H10
Elizabeth	G10	John	H10
Emily M.	E9	Jonas (Doct)	C9
Monica A.	G11	Judith	H10
Monica Aspasia	G11	Lucy B. Taylor	122
Sally	G11	Martha B.	I9
Sidney Sherwood	G11	Murray E	I9 / 122
Sylvester S.	G11	Orren	210
William /Wm.	G11	Orrin	213
		Polly	C9
		Sally	H9
BRADSHAW		Salome	210
Betsey M.	F6	Sarah d1840	H10
William	F6	Sarah B.	H10
		Sarah (Sara) I.	I9
BRESINGER		Sarah I d1876	I9
Linda	128	Solomon	H9
		Urial	I9
BREWSTER			
Joseph M. (Rev.)	D10	BROOKS	
Joseph Marsh (Rev.)	D10	Grace B.	1-5
Lot W.	11-9	Lyndon R.	1-5
Martha L.	11-10		
Mary Freeland	D10	BUNNELL	
		Devon C.	G8
BROWN		Mickey J	G8
2 infant children	H9		
Ann	C9	BUNT	
Bessie C.	I9	Clayton F.	1-15
Castanas	223	Marjorie A.	1-15
Celia Ann	C9		
Charles S.	I9		

BURBY			CONE	
Emma A.	111		Anna	A10
BUTTS - BUTS			Daniel	B10
Abigail	C8		Daniel, Jr.	B10 / C11
Johnathan	D8		Emaline	A10
Laura	D8		Lucy Ide	C11
Lydia L.	D9		Martha Ann	A10
Mary	D9		Olive d1833	A10
Nathaniel	D9		Olive d1840	B10
Polly	D9		Samuel (Dea)	A10
Rufus (Dea.)	C8		CORBETT	
Rufus M.	D8		William J Jr.	6-13
Sophronia D.	D9		CORNELLIER	
CADY			Paul F	6-15
Cyrine	H9		Janet F. Swope Battaini	6-15
Lewis	H9		CORNWELL	
CASE			Brewster L.	11-6
Hannah	A12		B. Evelyn. Wesley	11-4
CLARK			Bruce Melvin	10-4
Joseph (Dea.)	G12		Charles H.	11-7
Sarah	G12		Ellen M.	11-7
COLE			Madeline E	11-5
Clara M.	4-2		Robert W.	11-4
Doly	6-5		CROSHER / CROSSIER	
Ezra (d1843)	6-1 / 6-3		Andrew	D8
Ezra Jr. (d.1814)	6-4		Catherine	D8
John D.	4-3		Charlotte W.	D8
Lovina Cole Ayres	4-5		John	D8
Lovina	4-2		Lewis B.	D8
Nelson S.	4-1		Susan	D8
Riley A.	5-3		CULLETT	
Spencer	5-5		Leona Berry	9-20
Susan	6-2		William A.	9-20
CODY			CURTIN	
Patty	112		Dorothy Deveraux	A12
COLBY			Frederick John	A12
Helen Colby Berry Lambert	9-20		Helen Curtin Holt	A12

CULVER			EMERSON	
Ina	8-12		Charles G.	E8
			Madeline D	E8
DARBY			EMMONS	
Shannon Marie	G8		Laura	H10
DOLBY			EVANGELISTA	
Jane E.	3-4		Anna M.	6-13
DRAKE			EVERETT	
Leon I	9-12		Andrew	C8
Ruth M. Reynolds	9-12		Mary S.	C8
DROSEHN			FERGUSON	
Donald J.	7-1		Darius	C11
Edward L.	7-13		Elizabeth	C10 / C11
Edwin C., Sr	7-1		Emeransia	C11
Edwin C., Jr	7-1		John	C10 / C11
Fred F.	7-2		Lewis 1	C11
Frank W	7-2		Lewis 2	C11
James H.	7-2		Sidney	C11
Jean E Miller	7-15		FERRY	
Kathleen E. Sanderson	7-1		Elizabeth A.	8-11
Nettie C. Landau	7-2			
DuCHARME			FITCH	
Clifford F.	1-18		Almeda	I11
Florence L.	1-18		Catherine C.	I11
EDWARDS			Freddy	I11
A.L.	183		Freddy R.	I11
Albert L.	183		Julia I.	I11
Ellen J.	135		Mary H.	I11
C. Maria	135		Milton	I11
Sarah E.	183		Seraph	I11
Sarah M.	183		Walter H.	I11
Susan	183		William	I11
Susan B	183		FOOT	
Wm. A.	135		David	E12
ELLSWORTH			Euretta	H10
Betty J.	E8		Harlow	H10
			Infant Son	H10

FORD		Amasa	H12
Anna	119	Augustus C.	H10
Charles	119	Augustus C. (Capt.)	H10
Harris	119	Charlotte	F12
Lora V.	119	Chloe Ann	H10
		Ebenezer	F12
FRANKLIN		Franklin	F12
Florence L. Kilbourne	11-1	Hannah	H10
Lewis	11-1	John	F12
		Judith	F12
FRARY		Laura Emmons	H10
Lena E.	H10	Lemuel	F12
Luman W.	H10	Mary S.	H12
		Martha Emeline	F12
FRENCH		Ruth	F12
Belinda	B9	Sabra	H12
Cornelius D.	B9	Seraph	H10
Cynthia	B9	Socrates	H12
Cynthia R.	B9	Susan W.	H10
Edward N.	B9	Thomas	H10
Issac	B8	Thomas (Capt.)	H10
John Burton	C9	Walter	F12
Julia Ann	B9	Wm.	F12 / H10
Martha A.	B8	William / Wm. Esq.	F12
Mary	B8	William, Junr	F12
Mary E d1826	B9	Zerviah	H12
Mary E d1853	C9		
Otis	B8	FULLER	
Parny	B8	Cordelia	I12
Rebecca Robbins	B9		
Rebekah	B8	FURGUSON	
Samantha Sofia	B9	Sarah	122
Sarah	B8/ B9		
Sarah Maria	B9	FURNALD	
Silvester	B9	Ruth L.	137
Sylvester	B9		
Sylvester B.	C9	FRUSCIENTE	
		Alice	1-17
FRESHLER		Baby	1-16
David L	A11	Edwin 'Ted' Pilson	1-16
		Jean Alice	1-16
FRISSELL		Martin (d. 1977)	1-16
Abigail	H12	Martin Jr (d. 2018)	4-21
Albert	F12	Samuel 'Sammy'	1-17

Virginia A. Klein	4-21	Welcome I.	C12
GARDNER		GILBERT	
Clara M.	142	Affa	204
		Benson	C9
GEER		Elijah	C9
Almena	C12	Mary	C9
Alpheus	9-5		
Benjamin J.	B11	GLEASON	
Calvin d1807	C11	J. B.	A10
Calvin 2 nd d1821	C11	Laura E.	A10
Charlie	I12	R.	A10
Chauncey B.	B10		
Cordelia M.	B10	Glendenning	
Cornelia Ann	9-3	Orpha D.	11-21
Emily O.	C12	Fanny B.	11-19
Horace	C11		
Infant Geer (w/ Marilla)	B10	GREEN	
Ira	C11	Arthur	9-17
Ira Milo	3-1	Charles W.	9-17
Jewett	C11	Martha	9-17
Jewett H.	I12	Pearl A.	9-18
Joanna	B12	Bertha Wheeler	9-17
John	B11		
Kezia	8-1	GRIFFITH	
Keziah Judd	9-6	Florence O. Griffith	D7
Limon	C11		
Lucena V. (Barnes)	11-16	GOLDTHWAITHE	
Lucy	C11	Calvin	B8
Lucy A.	C11	E.	H11
Luther	B12	Elias	H11
Lyddia	B12	Eliza M.	H11
Lyman A.	9-4	E. M.	H11
Maria	8-1	Joseph	B8
Marilla N.	B10	Mary	B8
Mary C.	I12	Warner	H11
Maryett	B12		
Milton	C12	GRISWOLD	
Onnah	B11	Georgie W.	3-9
Peter	B12	Maryetta	3-9
Polly	B12	William	3-9
Polly M.	B10	Willie L.	3-9
Sally L.	B12 / C12		
Sherman	B10		

GUILD		HATHAWAY – HATHERWAY	
Loren	E9	Abigail	180
GUY		Elizabeth	C10
Cossette T.	I10	Esther	196
David M	I10	James	181
Judy Vogel	I10	James D.	C10
Roland A.	I10	John	196
HALVORSEN		Matie I Hathaway Bishop	138
Paul	121	Polly G.	C10
Richard A	226	Seth	C10
HANNUM		Shadrack	184/185
Allen Warner	B9	Susanna	184
Athniel	B9	HEATH	
Martha	B9	Gertrude A.	1-11
Othniel	B9	HERRICK	
Patty	B9	Jerusha	E12
HARWOOD		HIBBEN	
Marion I	100	Eliza	D9
HASKELL		HOLBROOK	
Allen	I11	Anna Pierce	163
Bertha	I11	Isaiah D.	162
Carrie G.	3-3	HOLCOMB	
Delesa	E12	Leora	165 / 166
George H	I11	Lorey	165
Hannah E	I11	HOLMES	
Hermon	E12	Alvan	B10
Jane E.	3-6	Jane M.	B10
Jane E. Dolby	3-4	Mariah	B10
Lester	3-4	Rosanna	B10
Lester	3-5	HOLT	
Lucy A.	I11	Helen Curtin	A12
Mary	H9	McPherson	A12
Nathan W.	3-4	IDE	
Nelson W.	3-4	Cyrus (Uncle)	C11
Noah D.	3-4	David	C11
Roger	H9		
Unity	E12		
Zechariah d1860	E12		
Zechariah d1830	E12		

Lois Matthews	C11	KUSIAK	
Lucy	C11	Frank J	3-21
Molly	C11		
Oliver	C11	LAMBERT	
Rebecah	C11	Helen Colby Berry	9-20
JACKSON		LAMBSON	
Adelfert P.	170	Gertrude A. Heath	1-11
Betsey	169	Roland H.	1-11
Electa	171		
Joel	168	LANDAU	
Marshall	172	Nettie C. Landau	7-2
JUDD		LATHROP	
Keziah Judd Geer	9-6	John S.	H9
KEEFE		LAROCHELLE	
Thomas P	207	Steven P. LaRochelle	10-21
KILBOURNE		LEALAND - LELAND	
Mary A.	11-2	Alatheia	D10
Nellie C.	11-3	Hepzibah	D10
Florence L.	11-1	J. (Rev.)	D10
W. H.	11-2	John (Rev)	D9 / D10
		Lenard	B8
KLEIN		Levi	D10
Virginia A. Klein	4-21	Lydia	D10
		Moses	B8
KNIGHT		LITTLE	
Arthur Leroy	I10	Amos H.	A10
Harriet	I10	Anne	F10
Joseph (Rev)	I10	Ezekiel (Capt.)	E9
Mary Evelyn	I10	Lucy	F10
Ruby H.	I10	Molly	F10
KNICKERBOCKER		Samuel E.	A10
Margret	I11		
Wm.	I11	LOOK	
KRUPSKI		Albert F.	B9
Francis E.	I12	Cheny	B9
Stanley F	I12	Cheney	B9
		H. S. A.	B9
		Jane	B9

J. L.	B9	MAXWELL	
Lucius A	B9	Samuel	C12
Lucius (Capt.)	B9		
Melvin F.	B9	McAVOY	
Rebecca	B9	Bernard	103
Rebeckah	B9	Hazel	103
Thomas A.	B9		
		MEACHAM	
LOOMIS		Ambrose	D12
Abigail A.	D8	Electa	D12
Calvin A.	D8		
Lyman A.	C9	MESSENGER	
Rusel E.	C9	Alvin H	A12
Sarah Maria	D8	Cyrus d1780	A12
Susanna	C9	Cyrus d1816	A12
		Hannah Case Messenger	A12
LOVELAND			
Rosetta M.	E12	MILLER	
		Jean E	7-15
LYMAN			
Infant	7-6	MINER	
Isaac	7-10	Affa	202
Martha	7-8	Christopher	197/198
Nancy M.	7-5	Deborah	203
Sarah A. (d1860)	7-4	Demmon	222
Sarah A. (d1844)	7-9	Dolly	201
		Henry	222
MACKENZIE		Lucy	222
Virginia Viola	3-17	Lucy (d1825)	197
		Nathan	200
MAGNIN		William	203
Joseph A.	104		
Mary Swartout	104	MINOR	
Maude	104	Esther	E11
Wallace	104	Joseph Treat	E11
		Treat	E11
MARTINDALE			
Cora E. Rowe	216	MONGON	
Willard W	216	Bruno	I11
		Hellener	I11
MATTHEWS		Julia	I11
James	C11		
Lois	C11		

MORRISON			PELKEY	
Mary V. Shea	I10		Alicia D.	1-7
Wallace G	I10		Coralie E.	1-20
			Laura C.	1-21
NASH			Nelson D. Sr.	1-7
Betsey d1837	H10		Nelson D. Jr.	1-20
Betsey d1848	H10			
C.F.	H10		PELTON – Not in Peru. Moved to Hinsdale	
E.	H10		Laura T.	75
Edward T.	H10		Alson H.	75
E. T.	H10			
J.	H10		PERKINS	
Jonathan	H10		Daniel	C8
Johnathan Jun.	H10			
Johnathan Alvan	H10		PERRY	
Oliver	H10		John	G10
			Betsy	G11
OAKES				
Gerald F	E8		PHELPS	
Betty J. Ellsworth	E8		Dana C.	D9
			Rita F.	D9
OLDS				
Almira	C10		PHILLIPS	
Reuben	C10		Chloe	B11
			Ebenezer	B11
ORPIN			Lewis	B11
Marion	10-2		Lydia	B11
Ernest	10-2		Lydia Isabella	B11
Helen	10-2		Marilla	B11
			Mary Ann	B11
PARKER			Persis	B11
Samuel	C8		Sarah	B11
			Smith	B11
PARSONS			Smith (Dea.)	B11
Lydia K.	I10		Stephen J.	121
Maria	I10			
Thomas	I10		PIERCE – PEIRCE - PIRCE	
			Aaron	F10
PARTRIDGE			Alvan B.	F8
Asa B.	E10		Anna Pierce Holbrook	163
Mary C.	E10		A. Sidney	174
			Barshabe	178
			Benjamin	160

Bertha L.	120	Shadrach	F9
Charles W, d. 1815	175	Tamerson	F9
Charles W. d. 1816	175	Wesley A.	110/112
Chloe Ann	F10	Wilber	120
Deborah Miner	203	Wilfred W.	101
Dolly	157	William R.	111
E.A.	113	W. R.	113
Ebenezer	F10		
Ebenezer, Esq.	F10	POWELL	
Electa	F10	Charlotte	4-8
Eli	D12	Dorance	4-9
Eliza Hibben	D9		
Eliza H. Thompson	D9	PROVOST	
Emma A. Burby	111	Marie	109
Emory	158		
Eunice (d1826)	F10	RICHARDS	
Eunice (Wightman)(d1812)	176	Bethiah	E9
Eunice W. (d1824)	173	Edward Palmer	5-16
Florence B.	113	Eric 'Steven'	5-16
Floyce Tower	118	Sarah Christine	5-16
Henry	173	William (Col.)	E9
Henry B.	112/116		
Henry, Esq.	176		
Isaac (Capt.)	F8	REYNOLDS	
Isaac S.	D9	George W.	9-13
James M	112 / 117 / 119	Ruth M	9-12
Lavancia Mariette	182	Clara Wheeler	9-13
Levi	178/179		
Levi (Col.)	157	ROBBINS	
Lydia	F10	Rebecca	B9
Lydia D.	112/115		
Lydia K.	F9	ROCKWELL	
Lydia M.	158	Amasa (Maj.)	D11
Mary	D12	Elisha	E12
Mercy	161	Eunice	E12
Minerva	177	Ida	D11
Orlen	157	Jennie	D11
Polly	F8	Olive	D11
Rebecca	159		
Roah A.	101	RODGERS	
Roberta A.	101	David Brainard	C11
Rollin	159	Edward Payson d1830	C11
Sarah E. (d1880)	112	Edward Payson d1838	B11
Sarah E. (d1904)	112	Joseph W.	B11 / C11
Shadrack	F9	Onnah	B11 / C11

ROSS		Catharine	C8
Alce	H10	Charles S.	C8
Amasa	E11	Edwin	133
Lemuel	H10	John W.	C8
Lucy A.	H10	Lottie P.	134
Sarah	E11	Mary L.	C8
Sarah E.	H10	Steward	C8
ROWE		SHUTTLEWORTH	
Cora E. Martindale	216	Edward K.	D7
		Florence O. Griffith	D7
RUSSELL		Merlynn R.	9-15
Cody Joseph	7-21	William O	9-15
Frank	7-20		
Jennifer E.	7-20	SMITH	
Lealon 'Sonny'	7-20	Alice M.	107
		Dolly	D8
SAKOWICZ		Infant	D8
Doreen	I12	Herbert N.	107
		Josiah	150
SANDERSON		Sally Ball	150
Kathleen E.	7-1	Sally S.	150
		Ura M. Smith Torrey	102
SCOTT		SPALDING	
Peter	A11	Alfred	B10
SEARS		Asa (Maj.)	B10
Darwin Rush	A11	Infant	B10
Sophia	A11	Mary	B10
Thomas (Doct)	A11		
SEVERY		SPAULDING	
Betsey J.	7-3	D.W.	I10
Nancy	7-3	Lovice M.	I10
Nancy A.	7-3		
Reuben S.	7-3	SPENCER	
		Polly	G11
SHEA		SQUIRES	
Mary V	I10	Alice M. Squires	9.9
		D. M.	4-6
SHUMWAY			
Caroline M d1835	C8		
Caroline M d1838	C8		

STANDISH		Eunice	F9
Lydia	6-1	Franklin	G10
Nathan	6-1	Harriet B.	E12
		Harvey	E12
STANTON		Hiram d1826	E12
Timothy L. Jr.	108	Hiram d1802	F9
Todd Michael	221	Hyla	I12
		Hyla Cleopatra Watkins	I12
STEARNS		Irving	F6
Harwin A.	225	Infant son	C12
		James C.	E12 / F12
STEDMAN		Jane C.	H9
Stacey D.	A11	Jerusha Herrick	E12
		John M.	E12
STEELE		John M. (Dea.)	E12
Charlene F	1-13	Joseph C.	H9
Coralie E.	1-20	Lois	C12
Eleanor M	1-14	Lucelia M.	E12
Laurin R.	1-6	Lydia	G10
Murielle L.	1-6	Margarette	E12
Robert R.	1-14	Margret	E12
		Mary Elizabeth	E12
STEVENS		Minnie A.	F6
Chester	E10	Milo	E9
Chloe	D10	Nathaniel	C12
Mercy	D10	Nathl. E.	F9
Oliver	D10	Olive M.	E12
William	D10	Sarah B.	G10
		Sarah E.	E12
STONE		Sarah Elizabeth	E12
Mary E.	I11	Susan A.	E12
Ward N.	I11	William W.	F12
STOWELL		STREET	
Austin	I12	Richard (Dick)	129
Ashley Livingstone	I12	Marie	129
Almira R.	H9		
Abigail	C12	STUKEY	
Asenath	F9	Sibyl C.	I9
Azel	C12		
Charles I.	F6	SWAURTOUT	
Cyrus, Esq.	F9	Mary Magnin	104
Eddie	E12		
Emily	E9		

TAYLOR		Sherman 2nd d1796	E9
Celia	123	Sarah d1852	G12
Henrietta Cowenhoven	A12	Sarah d1816	G12
Loomis Hammond	A12	Sibbel	C11
Lucy B.	122	Simeon	C11
Rosetta M	E12	Simeon, Esq.	C11
Roswell B.	123	Smith	G12
THOMAS		TORREY	
Eliza	E12	Amelia M. Blowers	218
Nellie A	I12	Armeda	214
William	E12	Betsey L.	214
THOMPSON		Betsey A.	141
Aaron E. (AET Footstone)	E9	Ezra	214
Abigail	G12	Hazel Torrey McAvoy	103
Amherst	G12	James M	102
Anna	8-5	Kenneth F	100
Art.	E9	Lizzy B.	136
Artemas	D9	Matie Hathaway Bishop	138
Artemas, Esqr.	D9/E9	Marion I Harwood	100
Clark P.	120 / G12	Robert W	137
Daniel	C11	Ruth L. Furnald	137
Dolly	D9	Sarah A.	214
D. W. C.	G12	Timothy T	217
Elias	8-6	Thomas E.	139
Eliza H.	D9	Thomas J	140
Elizabeth	E11	Ura M. Smith	102
Hannah	120 / G12	TOWER	
Harriet	D11	Archie L.	118
Hepziaeh	D9	Floyce Pierce Tower	118
Hipsey	D9	TRACY	
Hipsy	D9	Electa	G12
Hiram	C11	Nathaniel	G12
John	G12	Susanna	G12
Joseph d1795	G12	Traylor	
Joseph (Dea.)	G12	J.	1-19
Joseph d1827.	120 / G12	TUTTLE	
Joseph A.	G12	David (Col.)	E11
Lucy	E9	David M.	E10
Lucy Thompson Bottum	C12	Esther	E11
Nathan	D9 /D10		
Peter	E11		
Polly	D9 / D10		
Sherman d1795	E9		

Infant Son	E10	B. Evelyn. Wesley	11-4
John M.	E10		
Sarah	E10		
VON GLAHN		WETZEL	
Edward	4-11	Ina K	11-18
		William F	11-20
VREELAND		WHEELER	
Donald	8-15	Alice M. Squires	9-9
Madeline	8-15	Arthur S.	9-9
WATKINS		Bertha Wheeler Green	9-17
Abigail	E12	Charles S.	8-12
Clara	I12	Clara Wheeler Reynolds	9-13
Cleopatra	I11	Clarissa G.	9-1
Cordelia Fuller	I12	Cortney S.	8-11
Cullen B.	I11	Edwin I.	9-9
Dolly	I12	Elizabeth A. Ferry	8-11
Dorcas	F10	Ina Culver	8-12
Howard	I12	Nathan W.	9-2
Hyla Cleopatra	I12	Ronald S.	8-9
James	F10	William A.	9-9
Julia	I12	Willis A.	9-7
Patty Cody	I12		
Samuel d1854	I12	WEILAND	
Samuel T. d1887	I12	Eric	2-13
Zachariah	F12		
Zachariah (Dea)	E12	WEILAND-BOLIO	
Zenas	I11	Nathan Auguste	2-13
WEBB		WHELPLEY	
Betty L	8-8	Donald Howe	3-17
		Virginia V. MacKenzie	3-17
WEEKS		WHITCOMB	
Arthur W.	E8	Kathleen A.	5-20
Pearl E.	E8	Neal E.	5-20
WELLS		WHITE	
Maynard G.	5-4	Delight	D11
Alice M.	5-4	Dwight	D11
WETMORE		John	D11
William	G9		
WESLEY		WIGGIN	
		Carlos W.	7-13

WILLCOX		
Lois		164
Samuel (Lieut)		164
WILSON		
Pearl A. Green		9-18
Ernest		9-18
WINDOLOSKI		
Tommy R.		G8
WISNER		
Mary Ann		H11
WOOD		
Anthony		10-10
Arthur L.		10-10
May		10-10
Sarah E.		10-10
WORTHINGTON		
Affa Gilbert		204
David d1831		B10
David d1818	204/205	
Mary		B10
Samuel		B10
ZINK		
Charles W.		D8
UNKNOWN / UNREADABLE STONES		
Unknown		G11
Unknown – Footstone ‘S.C.’		I11
Unmarked Footstone		2-4
Unmarked Footstone		2-10
Unknown Footstone		5-2
Unmarked Stone		6-6
Unknown marker		145
Unknown marker		146
Unreadable		195
GLR Footstone		219
SAF Footstone		220